



Barmesa[®] Pumps

¡Líderes en Calidad!



Serie
BMV / BMVF

Índice

| | |
|--|-----------|
| Bomba y motor estándar | 1 |
| Aplicaciones y condiciones de operación | 1 |
| Nomenclatura | 2 |
| Cobertura hidráulica | 3 |
| NPSH | 4 |
| Operación en paralelo | 4 |
| Presión máxima de trabajo | 5 |
| Temperatura ambiente máxima | 5 |
| Materiales de construcción | 6 |
| Curvas de rendimiento BMV(F)1 | 8 |
| Curvas de rendimiento BMV(F)2 | 9 |
| Curvas de rendimiento BMV(F)3 | 10 |
| Curvas de rendimiento BMV(F)4 | 11 |
| Curvas de rendimiento BMV(F)8 | 12 |
| Curvas de rendimiento BMVF10 | 13 |
| Curvas de rendimiento BMV(F)12 | 14 |
| Curvas de rendimiento BMVF15 | 15 |
| Curvas de rendimiento BMVF16 | 16 |
| Curvas de rendimiento BMV(F)20 | 17 |
| Curvas de rendimiento BMV(F)32 | 18 |
| Curvas de rendimiento BMV(F)42 | 19 |
| Curvas de rendimiento BMV(F)65 | 20 |
| Curvas de rendimiento BMVF90 | 21 |
| Curvas de rendimiento BMVF120 | 22 |
| Curvas de rendimiento BMVF150 | 23 |
| Curvas de rendimiento BMVF200 | 24 |

Bomba

La bomba multietapas vertical es impulsada por un motor eléctrico estándar. La flecha del motor se conecta directamente con la flecha de la bomba a través de un acoplamiento. Los componentes del cilindro y el paso de flujo son resistentes a la presión y están fijados entre el cabezal de la bomba y la entrada y salida de la sección con pernos de anclaje. La entrada y la salida se encuentran en la parte inferior de la bomba en el mismo nivel. Este tipo de bomba puede estar equipada con un protector inteligente para prevenir eficazmente su funcionamiento en seco, un desfase o una sobrecarga.

Motor estándar

- ▶ Totalmente cerrados con ventilador exterior.
- ▶ 2 polos, 3 fases, 60 Hz, 230/460 volts.
- ▶ Protección IP55.
- ▶ Aislamiento clase F.

Condiciones de operación

- ▶ Líquido fino, limpio, no inflamable y no explosivo que no contenga gránulos ni fibras sólidos.
- ▶ Temperatura del líquido:
Temperatura normal: -15 °C ~ 70 °C
Agua caliente: -15 °C ~ 105 °C
- ▶ Temperatura ambiente: hasta 40 °C
- ▶ Altitud: hasta 1000 m

Aplicaciones

La bomba BMV(F) es una bomba vertical, la estructura de la tubería puede garantizar que las bombas se puedan instalar directamente en el sistema de tubería, con los diámetros de tubería iguales y la salida y la entrada al mismo nivel. Este diseño de estructura hace que la conexión de la bomba a la tubería sea más compacta. Tienen diferentes especificaciones y diferentes series, para cumplir con los requisitos de caudal y presión. Pueden transferir no solo agua sino también diversos líquidos para medios industriales, adecuados para diferentes temperaturas, caudales y rangos de presión. Las BMV(F) son adecuadas para líquidos no corrosivos y las BMV son adecuadas para líquidos corrosivos suaves.

Suministro de agua:

- ▶ Filtrado y transporte de agua.
- ▶ Partición de agua.
- ▶ Aumento de la presión neta para edificios de gran altura.
- ▶ Aumento de la presión del agua industrial.

Impulso industrial:

- ▶ Sistema de agua de proceso.
- ▶ Sistema de limpieza.
- ▶ Sistema de lavado a alta presión.
- ▶ Sistema contra incendios.
- ▶ Limpieza de automóviles.

Transporte de líquidos industriales:

- ▶ Sistema de refrigeración y aire acondicionado.
- ▶ Sistema de agua de alimentación de caldera.
- ▶ Sistema de temperatura, ajuste de máquinas.

Suministro:

- ▶ Aceite y alcohol.
- ▶ Ácido y álcali.
- ▶ Etileno, glicol y refrigerante.

Tratamiento del agua:

- ▶ Sistema de ultrafiltración.
- ▶ Sistema de ósmosis inversa.
- ▶ Sistema de destilación.

Riego:

- ▶ Riego por región.
- ▶ Riego por aspersión.
- ▶ Riego por goteo.

Nomenclatura

BMV(F)1, 2, 3, 4, 8, 10, 12, 15, 16, 20

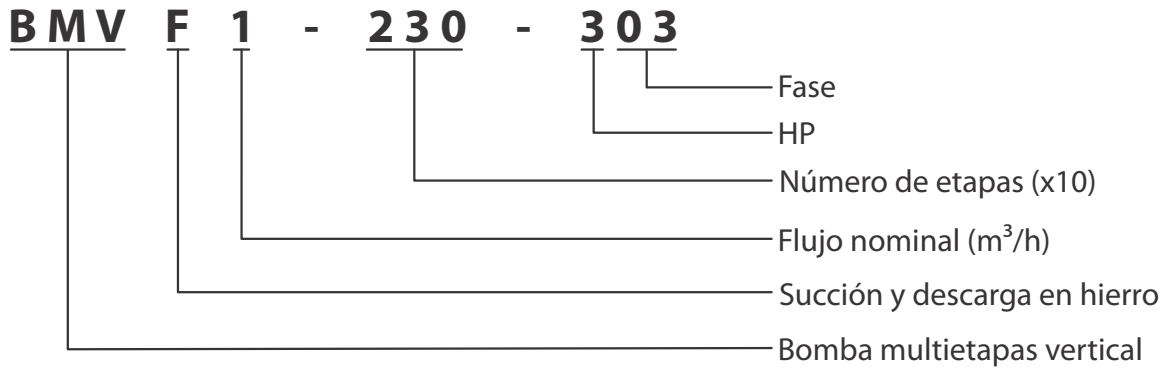

BMV(F)32, 42, 65, 90, 120, 150

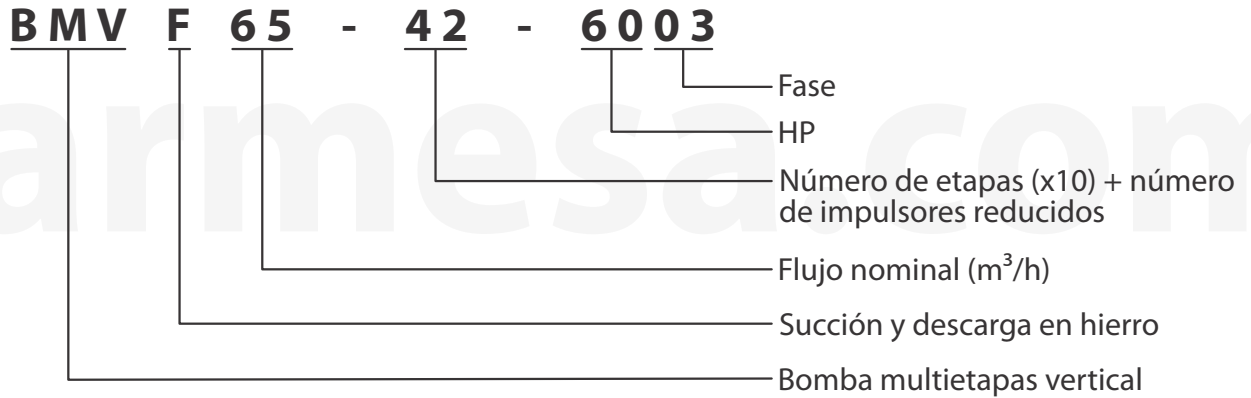

BMVF200

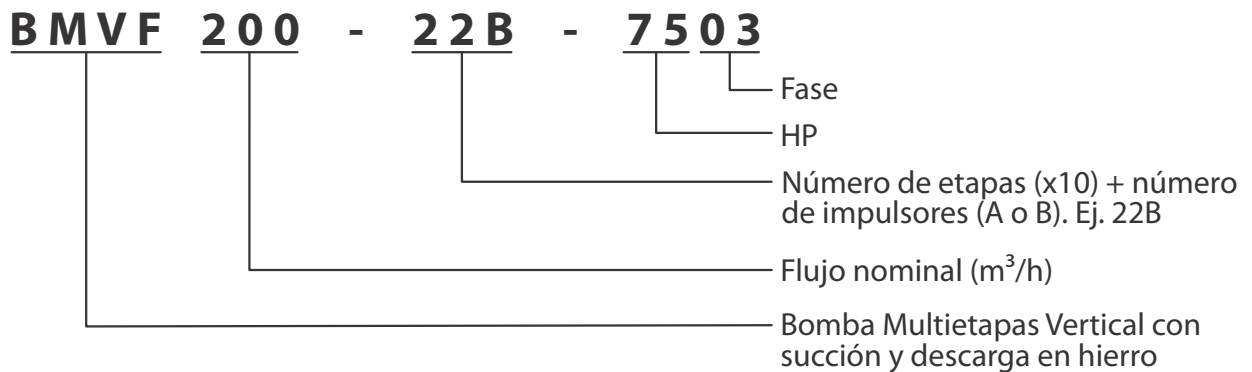

Cobertura hidráulica

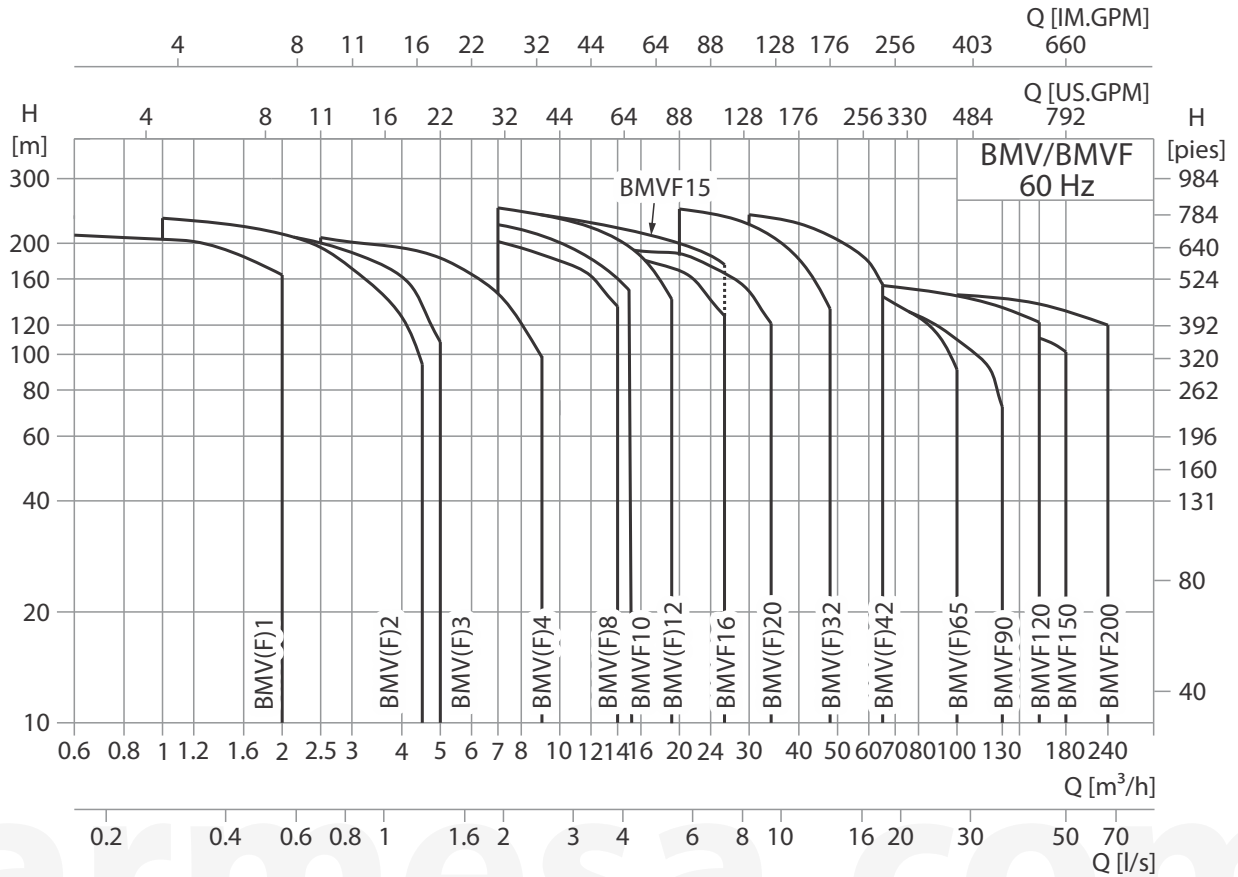

Especificaciones

| PARÁMETRO | BMV1 BMVF1 | BMV2 BMVF2 | BMV3 BMVF3 | BMV4 BMVF4 | BMV8 BMVF8 | BMVF10 | BMV12 BMVF12 | BMVF15 | BMVF16 |
|-------------------------------------|---------------|---------------|---------------|---------------|---------------|-----------|-----------------|------------|------------|
| Flujo nominal [m ³ /h] | 1 | 2 | 3 | 4 | 8 | 10 | 12 | 15 | 16 |
| Flujo nominal [l/s] | 0.28 | 0.56 | 0.83 | 1.1 | 2.2 | 2.8 | 3.3 | 4.1 | 4.4 |
| Rango del flujo [m ³ /h] | 0.6 - 2 | 1 - 4.5 | 1.5 - 5 | 2.5 - 8 | 7 - 14 | 7 - 15 | 7 - 19 | 9 - 26 | 10 - 26 |
| Rango del flujo [l/s] | 0.17 - 0.56 | 0.28 - 1.25 | 0.42 - 1.4 | 0.7 - 2.2 | 1.9 - 3.9 | 1.9 - 4.1 | 1.9 - 5.3 | 2.5 - 7.2 | 2.8 - 7.2 |
| Presión máxima [bar] | 22 | 23.5 | 23 | 21 | 20 | 25 | 25 | 24 | 20 |
| Capacidad motor [kW] | 0.37 - 3 | 0.55 - 4 | 0.37 - 4 | 0.75 - 5.5 | 0.75 - 11 | 1.5 - 11 | 1.1 - 15 | 1.5 - 18.5 | 2.2 - 18.5 |
| Rango de temp. [°C] | -15 ~ 105 | | | | | | | | |
| Eficiencia máx. [%] | 44 | 46 | 54 | 57 | 62 | 70 | 63 | 73 | 66 |
| Brida | DN25 | DN25 | DN25 | DN32 | DN40 | DN40 | DN50 | DN50 | DN50 |

| PARÁMETRO | BMV20 BMVF20 | BMV32 BMVF32 | BMV42 BMVF42 | BMV65 BMVF65 | BMVF90 | BMVF120 | BMVF150 | BMVF200 |
|-------------------------------------|-----------------|-----------------|-----------------|-----------------|-------------|-------------|----------|-------------|
| Flujo nominal [m ³ /h] | 20 | 32 | 42 | 65 | 90 | 120 | 150 | 200 |
| Flujo nominal [l/s] | 5.6 | 8.9 | 12.5 | 17.8 | 25 | 33 | 41.6 | 55.6 |
| Rango del flujo [m ³ /h] | 12 - 34 | 20 - 48 | 30 - 65 | 40 - 100 | 60 - 130 | 60 - 160 | 80 - 180 | 100 - 240 |
| Rango del flujo [l/s] | 3.3 - 9.4 | 5.5 - 13.3 | 8.3 - 18 | 11.1 - 27.7 | 16.7 - 36.1 | 16.7 - 44.4 | 22 - 50 | 27.8 - 66.7 |
| Presión máxima [bar] | 20 | 25 | 26 | 18 | 15 | 15 | 14 | 15 |
| Capacidad motor [kW] | 2.2 - 18.5 | 3 - 30 | 5.5 - 45 | 7.5 - 45 | 11 - 45 | 18.5 - 75 | 15 - 75 | 30 - 110 |
| Rango de temp. [°C] | - 15 ~ 106 | | | | | | | |
| Eficiencia máx. [%] | 69 | 73 | 75 | 76 | 77 | 74 | 73 | 78 |
| Brida | DN50 | DN65 | DN80 | DN100 | DN100 | DN125 | DN125 | DN150 |

NPSH y operación en paralelo

Presión mínima de entrada NPSH

En caso de que la presión en la bomba sea inferior a la presión de vapor utilizada para evitar cavitaciones, se debe garantizar una presión mínima en el lado de entrada de la bomba. La succión máxima se puede calcular con la siguiente fórmula:

$$H = P_b \times 10.2 - \text{NPSH} - H_f - H_v - H_s$$

P_b = presión atmosférica [bar]

(se puede ajustar a 1 bar)

En un sistema cerrado, P_b significa presión del sistema [bar].

NPSH = carga de succión neta positiva [m] (si se puede leer desde el punto de posible caudal máximo mostrado en la curva NPSH).

H_f = pérdida en la tubería de succión [m].

H_v = presión de vapor [m].

H_s = margen seguro = cabezal de entrega mínima de 0.5 m.

Si el resultado calculado H es positivo, la bomba puede funcionar bajo la máxima altura de succión H.

En caso de que el resultado calculado H sea negativo, es necesario una presión mínima de entrada.

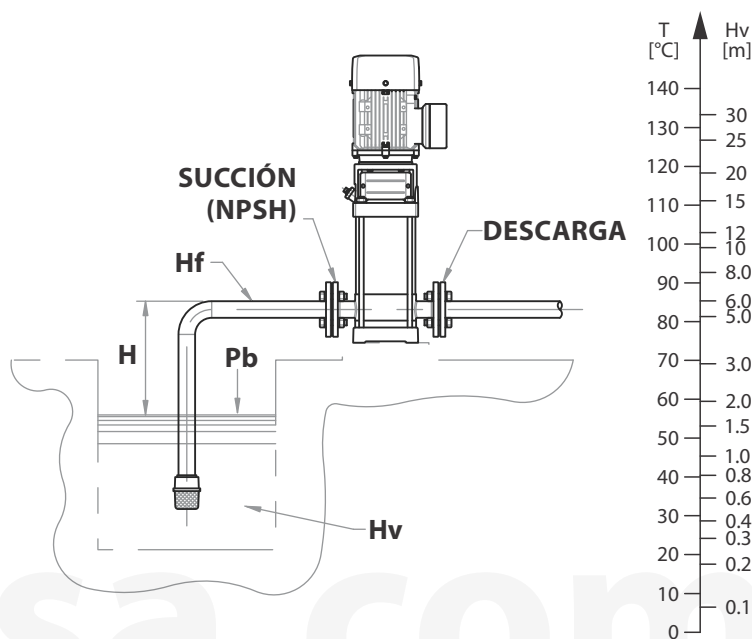

Compruebe y asegúrese de que la bomba no esté en estado de cavitación.

Operación en paralelo

La conexión de varias bombas en funcionamiento paralelo beneficiará más que la ejecución de una sola bomba grande.

- ▶ Aplicable a diferentes estados de trabajo necesarios en un sistema de flujo variable.
- ▶ Aumento de la posibilidad de suministro de agua cuando la bomba falla. Porque en caso de fallo de la bomba, solo se afecta parte del flujo del sistema.

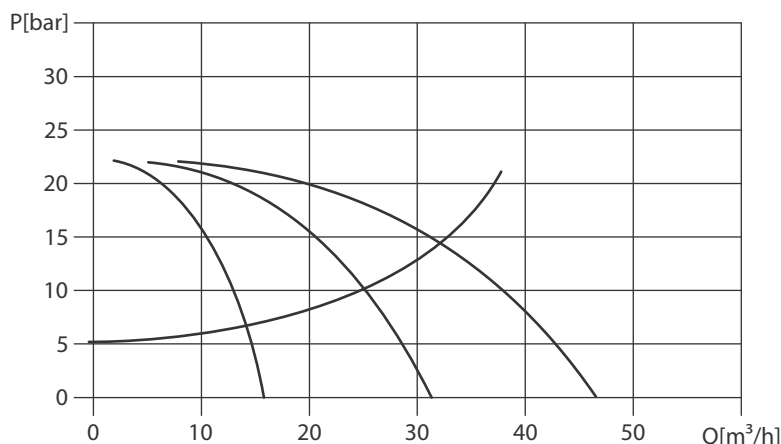

Se pueden conectar dos bombas o más en paralelo si es necesario.

Presión y temperatura máxima

Presión máxima de trabajo

La siguiente curva muestra la limitación de la presión y la temperatura, que deben estar en el alcance como se muestra en la curva.

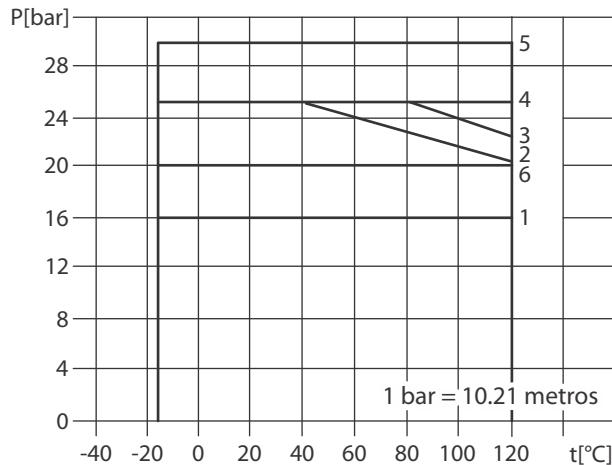

| MODELO | # CURVA |
|-----------------------------|---------|
| BMV(F)1, 2, 3 y 4 | 2 |
| BMV10 y 15 | 3 |
| BMV(F)8, 12, 16 y 20 | 3 |
| BMV(F)32 | |
| 32-22 ~ 32-552 | 1 |
| 32-60 ~ 32-92 | 4 |
| 32-90 | 5 |
| BMV(F)42 | |
| 42-20 y 30 | 1 |
| 42-42, 40, 50 y 60 | 4 |
| 42-70 | 5 |
| BMV(F)65 | |
| 65-20 y 30 | 1 |
| 65-42 y 52 | 4 |
| BMVF90 | |
| 90-20 y 31 | 1 |
| 90-42 | 4 |
| BMVF120, 150 y 200 | 6 |

Temperatura ambiente máxima

Cuando la bomba funciona a una temperatura ambiente superior a 40 °C o a una altitud superior a 1000 m, debido a la baja densidad del aire y los malos efectos de enfriamiento, la potencia de salida del motor P2 se reducirá en cierta medida. Si la bomba funciona en las condiciones mencionadas anteriormente, debe estar equipada con un motor de mayor potencia.

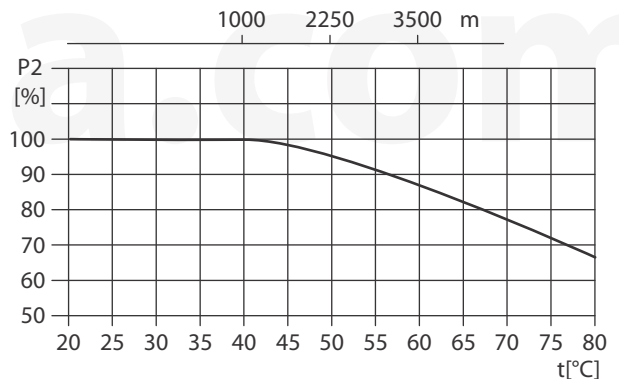

Materiales de construcción

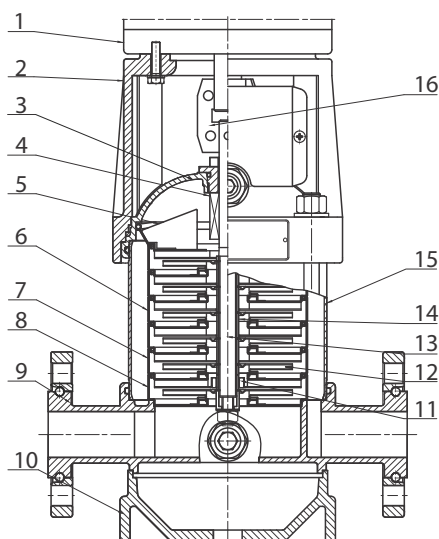

BMV1, 2, 3 y 4

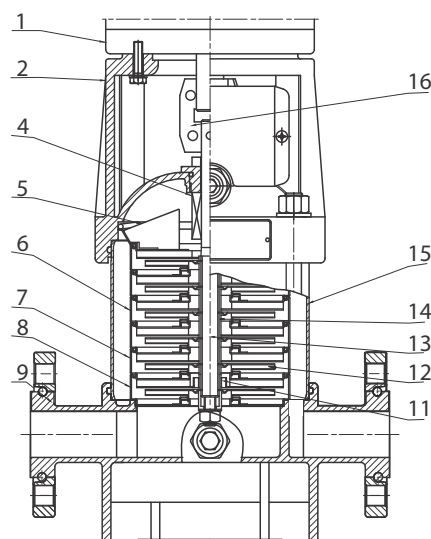

BMVF1, 2, 3 y 4

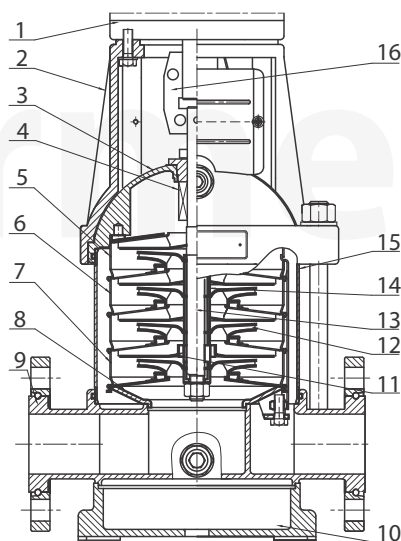

BMV8, 10, 12, 15, 16 y 20

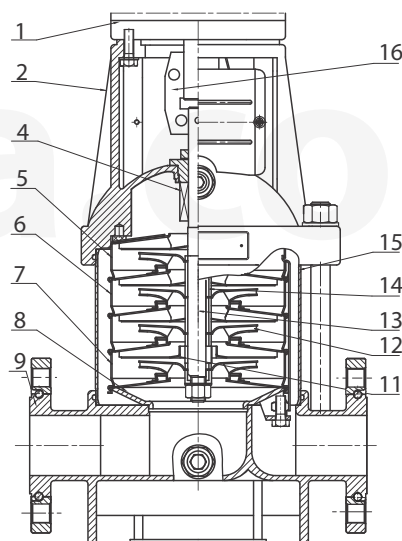

BMVF8, 10, 12, 15, 16 y 20

Materiales para BMV(F)1, 2, 3, 4, 8, 10, 12, 15, 16 y 20

| ITEM | DESCRIPCIÓN | MATERIAL | DESIGNACIÓN |
|------|---------------------|----------------------|--------------|
| 1 | Motor | - | - |
| 2 | Cabezal de la bomba | Hierro gris | ASTM 25B |
| 4 | Sello mecánico | - | - |
| 5 | Difusor superior | Acero inox. | AISI 304 |
| 6 | Difusor | Acero inox. | AISI 304 |
| 7 | Soporte de difusor | Acero inox. | AISI 304 |
| 8 | Inductor | Acero inox. | AISI 304 |
| 11 | Balero | Carburo de tungsteno | - |
| 12 | Impulsor | Acero inox. | AISI 304 |
| 13 | Flecha | Acero inox. | AISI 304/16L |

| ITEM | DESCRIPCIÓN | MATERIAL | DESIGNACIÓN |
|------|--------------|-----------------|-------------|
| 14 | Manguito | Acero inox. | AISI 304 |
| 15 | Cilindro | Acero inox. | AISI 304 |
| 16 | Acoplamiento | Acero al carbón | - |

BMV

| | | | |
|----|------------------------------|-------------|----------|
| 3 | Sello de la base | Acero inox. | AISI 304 |
| 9 | Cámara de succión y descarga | Acero inox. | AISI 304 |
| 10 | Placa base | Hierro gris | ASTM 25B |

BMVF

| | | | |
|---|------------------------------|-------------|----------|
| 9 | Cámara de succión y descarga | Hierro gris | ASTM 25B |
|---|------------------------------|-------------|----------|

Materiales de construcción

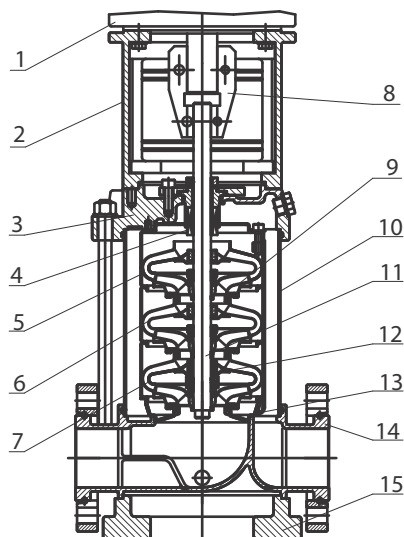

BMV32, 42 y 65

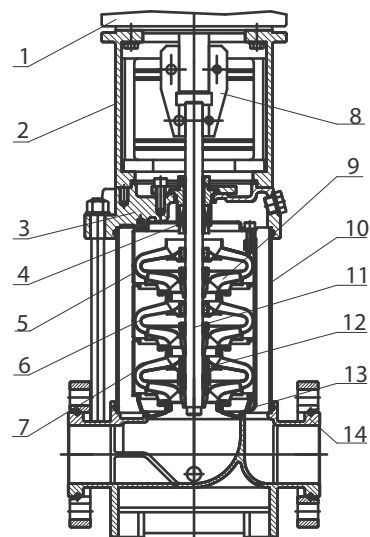

BMVF32, 42, 65 y 90

Materiales para BMV(F)32, 42, 65 y 90

| ITEM | DESCRIPCIÓN | MATERIAL | DESIGNACIÓN |
|------|--------------------|--------------------------------|-------------------------|
| 1 | Motor | - | - |
| 2 | Soporte | Hierro gris / Hierro dúctil | ASTM25B ASTM70-50-05 |
| 4 | Sello mecánico | - | - |
| 5 | Difusor superior | Acero inox. | AISI 304 |
| 6 | Difusor | Acero inox. | AISI 304 |
| 7 | Soporte de difusor | Acero inox. | AISI 304 |
| 8 | Acoplamiento | Hierro dúctil | ASTM70-50-05 |
| 9 | Impulsor | Acero inox. | AISI 304 |
| 10 | Cilindro | Acero inox. | AISI 304 |
| 11 | Flecha | Acero inox. | AISI 304/16L |

| ITEM | DESCRIPCIÓN | MATERIAL | DESIGNACIÓN |
|-------------|------------------------------|--------------------------------|-------------------------|
| 12 | Balero | Carburo de tungsteno | - |
| 13 | Inductor | Acero inox. | AISI 304 |
| BMV | | | |
| 3 | Cabezal de la bomba | Acero inox. | AISI 304 |
| 14 | Cámara de succión y descarga | Acero inox. | AISI 304 |
| 15 | Base | Hierro gris | ASTM 25B |
| BMVF | | | |
| 3 | Cabezal de la bomba | Hierro gris / Hierro dúctil | ASTM25B ASTM70-50-05 |
| 14 | Cámara de succión y descarga | Hierro gris / Hierro dúctil | ASTM25B ASTM70-50-05 |

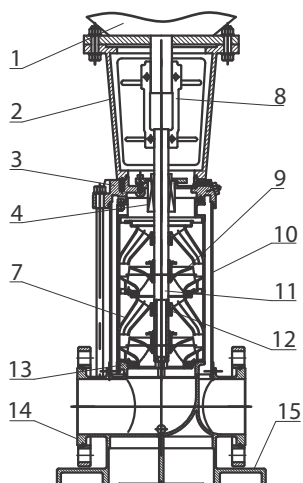

BMVF120, 150 y 200

Materiales para BMVF120, 150 y 200

| ITEM | DESCRIPCIÓN | MATERIAL | DESIGNACIÓN |
|------|------------------------------|--------------------------------|-------------------------|
| 1 | Motor | - | - |
| 2 | Soporte | Hierro gris / Hierro dúctil | ASTM25B ASTM70-50-05 |
| 3 | Cabezal de la bomba | Hierro gris / Hierro dúctil | ASTM25B ASTM70-50-05 |
| 4 | Sello mecánico | - | - |
| 7 | Difusor superior | Acero inox. | AISI 304 |
| 8 | Acoplamiento | Hierro dúctil | ASTM70-50-05 |
| 9 | Impulsor | Acero inox. | AISI 304 |
| 10 | Cilindro | Acero inox. | AISI 304 |
| 11 | Flecha | Acero inox. | AISI 304/16L |
| 12 | Balero | Carburo de tungsteno | - |
| 13 | Inductor | Acero inox. | AISI 304 |
| 14 | Cámara de succión y descarga | Hierro gris / Hierro dúctil | ASTM25B ASTM70-50-05 |

Curvas de rendimiento BMV(F)1

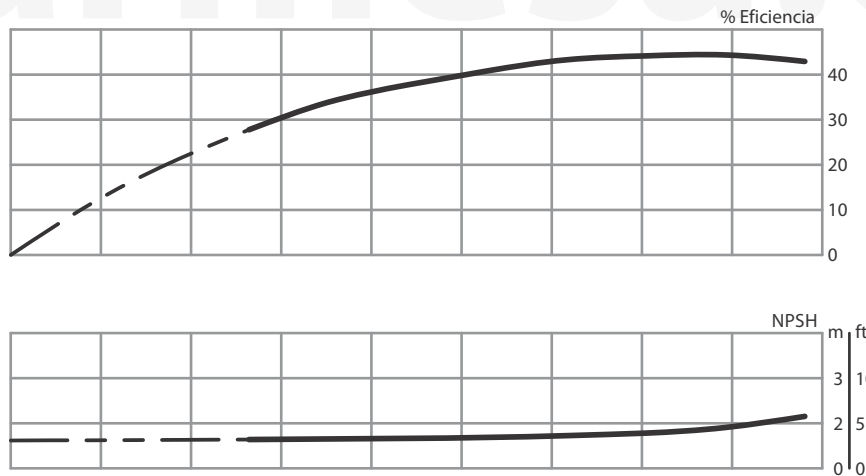
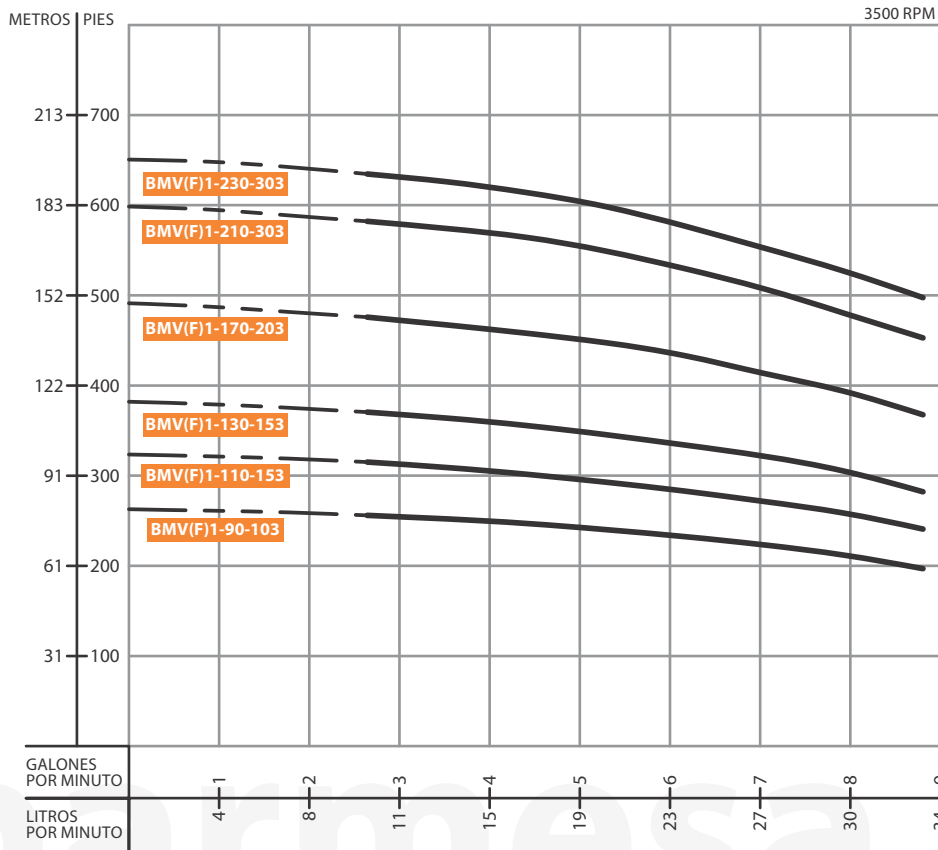

Dibujo de Instalación (mm)



Tabla de Rendimiento

| MODELO | PASOS | HP | Q (LPM) | | | | | | | |
|-----------------|-------|-----|---------|------|------|-----|------|------|-----|------|
| | | | 10 | 13.3 | 16.7 | 20 | 23.3 | 26.7 | 30 | 33.3 |
| BMV(F)1-90-103 | 9 | 1 | 76 | 75 | 74 | 73 | 71 | 66 | 64 | 60 |
| BMV(F)1-110-153 | 11 | 1.5 | 95 | 93 | 90 | 87 | 85 | 81 | 78 | 73 |
| BMV(F)1-130-153 | 13 | 1.5 | 112 | 110 | 107 | 105 | 100 | 95 | 93 | 86 |
| BMV(F)1-170-203 | 17 | 2 | 144 | 141 | 139 | 137 | 132 | 124 | 120 | 112 |
| BMV(F)1-210-303 | 21 | 3 | 177 | 174 | 172 | 168 | 162 | 153 | 147 | 138 |
| BMV(F)1-230-303 | 23 | 3 | 193 | 190 | 188 | 184 | 174 | 167 | 161 | 152 |

H (m)

Dimensiones y Pesos

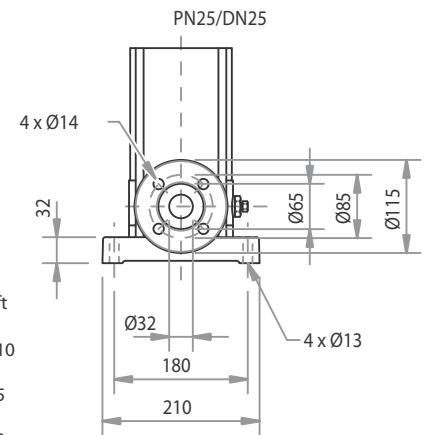
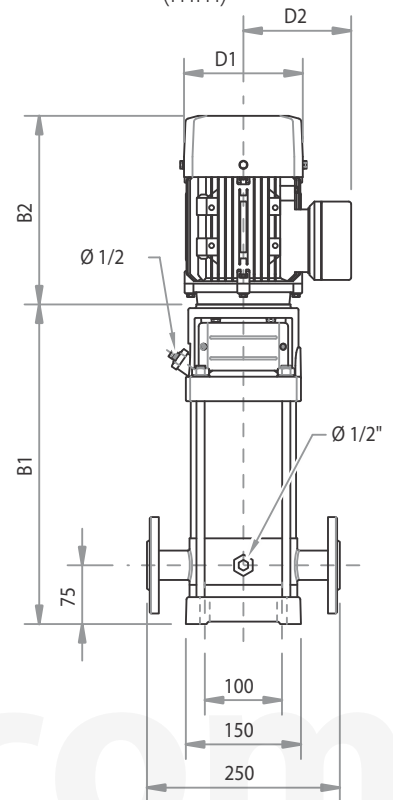
| TAMAÑO (mm) | | | | | PESO (kg) |
|-------------|-----|-------|-----|-----|-----------|
| B1 | B2 | B1+B2 | D1 | D2 | |
| 394 | 245 | 639 | 170 | 142 | 28 |
| 430 | 245 | 675 | 170 | 142 | 29 |
| 466 | 245 | 711 | 170 | 142 | 31 |
| 548 | 290 | 838 | 190 | 155 | 38 |
| 620 | 290 | 910 | 190 | 155 | 42 |
| 656 | 290 | 946 | 190 | 155 | 43 |

Curvas de rendimiento BMV(F)2

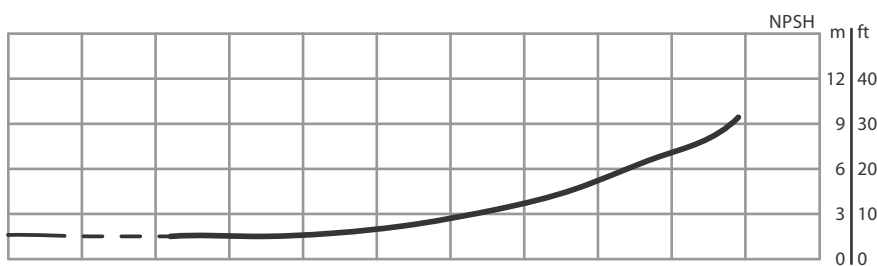
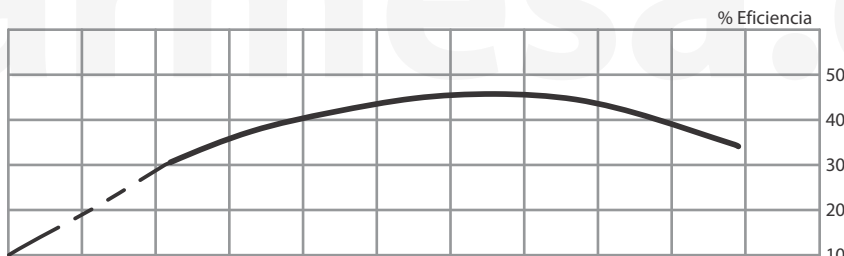
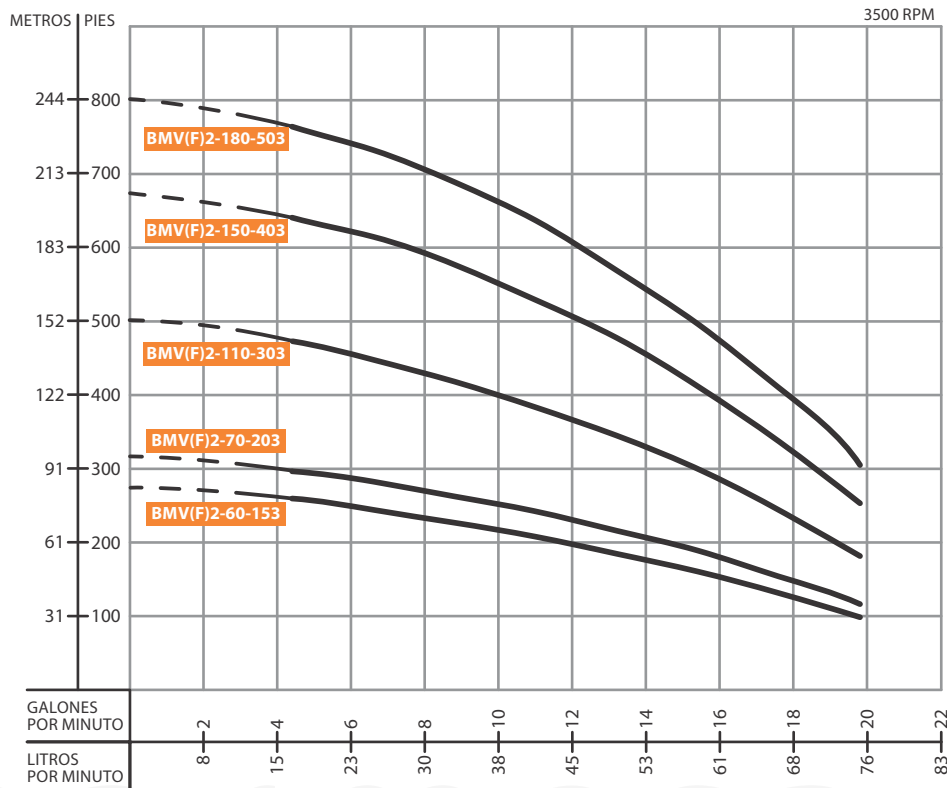

Dibujo de Instalación (mm)



Tabla de Rendimiento

| MODELO | PASOS | HP | Q (LPM) | | | | | | | |
|-----------------|-------|-----|---------|-----|------|------|-----|------|------|----|
| | | | 16.7 | 25 | 33.3 | 41.7 | 50 | 58.3 | 66.7 | 75 |
| | | | H (m) | | | | | | | |
| BMV(F)2-60-153 | 6 | 1.5 | 78 | 74 | 69 | 63 | 56 | 49 | 40 | 30 |
| BMV(F)2-70-203 | 7 | 2 | 91 | 86 | 81 | 74 | 66 | 57 | 47 | 35 |
| BMV(F)2-110-303 | 11 | 3 | 143 | 136 | 128 | 116 | 104 | 90 | 75 | 56 |
| BMV(F)2-150-403 | 15 | 4 | 195 | 186 | 176 | 160 | 142 | 125 | 103 | 77 |
| BMV(F)2-180-503 | 18 | 5.5 | 234 | 228 | 212 | 195 | 171 | 151 | 126 | 94 |

Dimensiones y Pesos

| B1 | B2 | B1+B2 | TAMAÑO (mm) | | PESO (kg) |
|-----|-----|-------|-------------|-----|-----------|
| | | | D1 | D2 | |
| 340 | 245 | 585 | 170 | 142 | 26 |
| 368 | 290 | 658 | 190 | 155 | 32 |
| 440 | 290 | 730 | 190 | 155 | 37 |
| 522 | 315 | 837 | 197 | 165 | 45 |
| 576 | 335 | 911 | 230 | 188 | 54 |

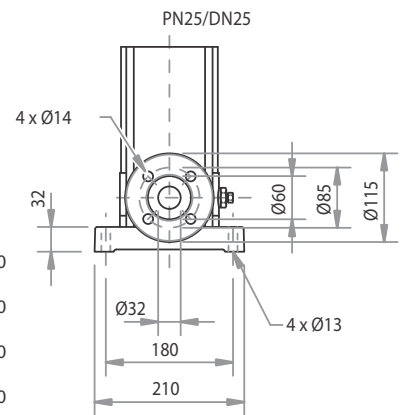
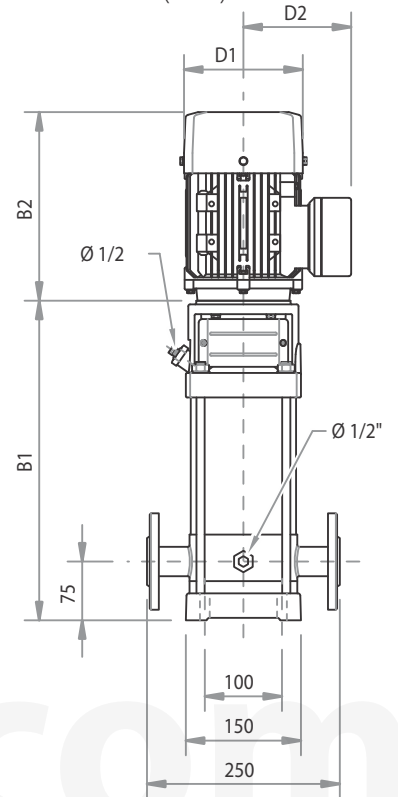
Curvas de rendimiento BMV(F)3

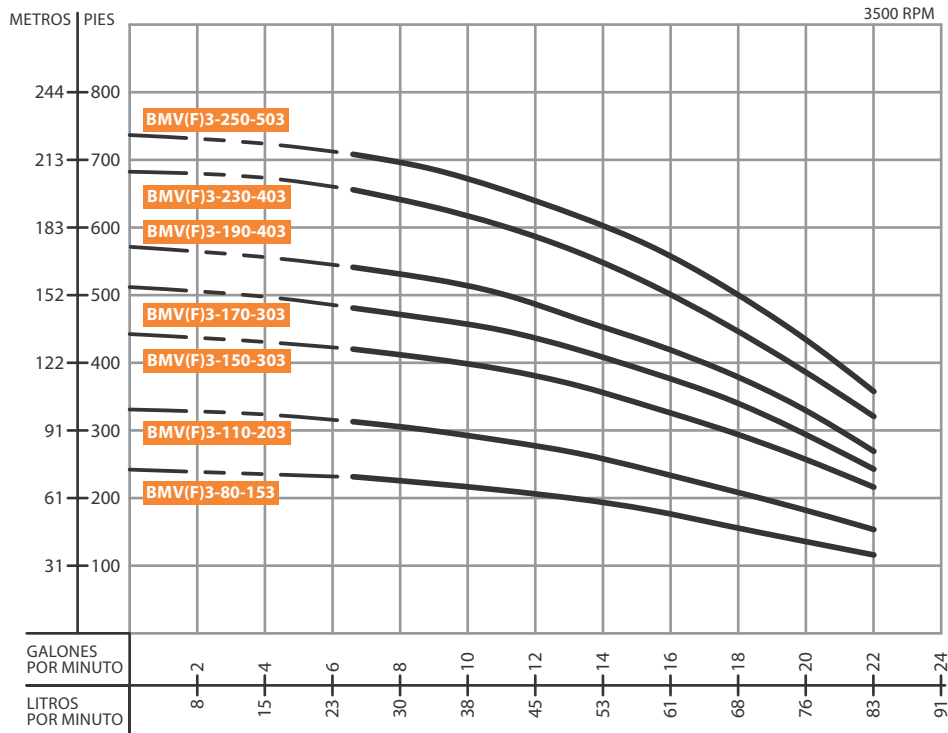

Dibujo de Instalación (mm)



Tabla de Rendimiento

| MODELO | PASOS | HP | Q (LPM) | | | | | | | |
|-----------------|-------|-----|---------|------|------|-----|------|------|-----|------|
| | | | 25 | 33.3 | 41.7 | 50 | 58.3 | 66.7 | 75 | 83.3 |
| | | | H (m) | | | | | | | |
| BMV(F)3-80-153 | 8 | 1.5 | 70 | 67 | 64 | 61 | 53 | 49 | 44 | 35 |
| BMV(F)3-110-203 | 11 | 2 | 96 | 92 | 87 | 82 | 74 | 69 | 59 | 48 |
| BMV(F)3-150-303 | 15 | 3 | 129 | 126 | 120 | 112 | 99 | 93 | 81 | 65 |
| BMV(F)3-170-303 | 17 | 3 | 147 | 143 | 137 | 128 | 114 | 106 | 91 | 74 |
| BMV(F)3-190-403 | 19 | 4 | 165 | 160 | 153 | 142 | 123 | 118 | 102 | 82 |
| BMV(F)3-230-403 | 23 | 4 | 200 | 194 | 185 | 174 | 154 | 142 | 122 | 98 |
| BMV(F)3-250-503 | 25 | 5.5 | 217 | 211 | 202 | 187 | 167 | 154 | 134 | 108 |

Dimensiones y Pesos

| TAMAÑO (mm) | | | | | PESO (kg) |
|-------------|-----|-------|-----|-----|-----------|
| B1 | B2 | B1+B2 | D1 | D2 | |
| 376 | 245 | 621 | 170 | 142 | 27 |
| 440 | 290 | 730 | 190 | 155 | 34 |
| 512 | 290 | 802 | 190 | 155 | 39 |
| 548 | 290 | 838 | 190 | 155 | 40 |
| 594 | 315 | 909 | 197 | 165 | 48 |
| 666 | 315 | 981 | 197 | 165 | 50 |
| 702 | 335 | 1037 | 230 | 188 | 58 |

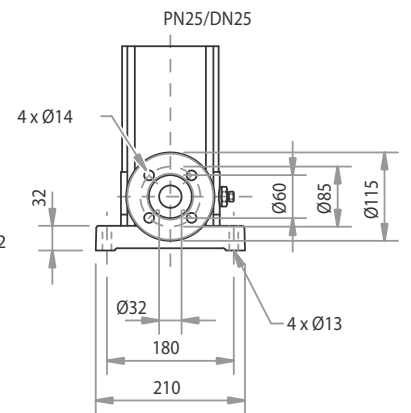
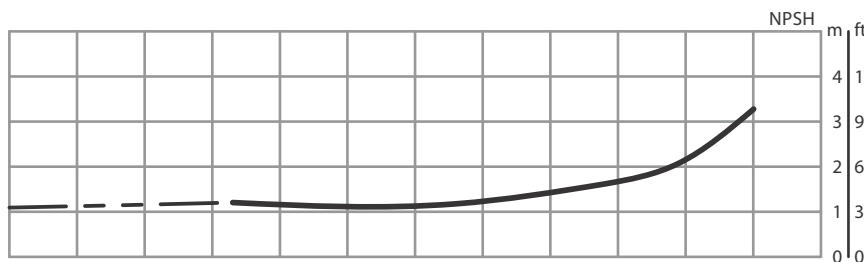
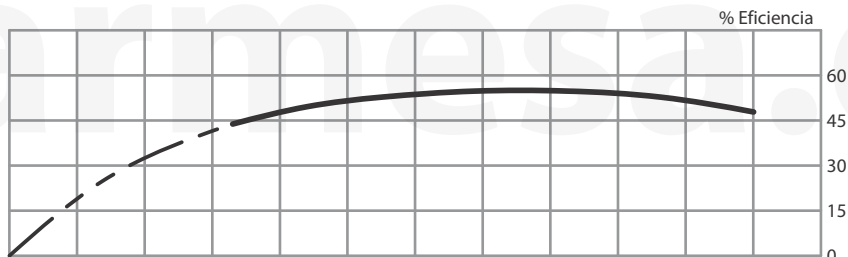
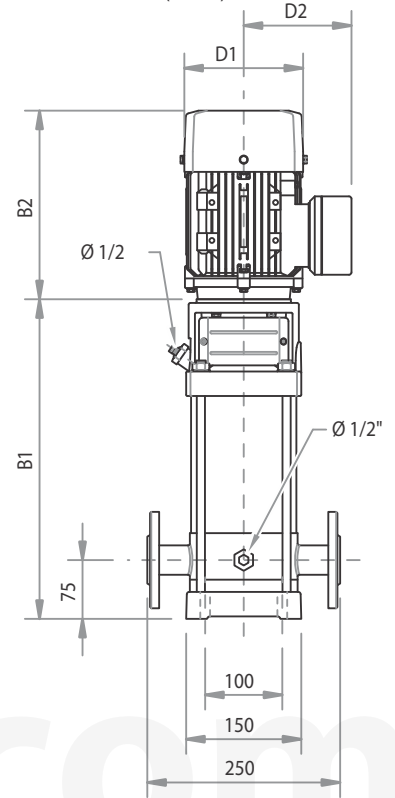
Curvas de rendimiento BMV(F)4

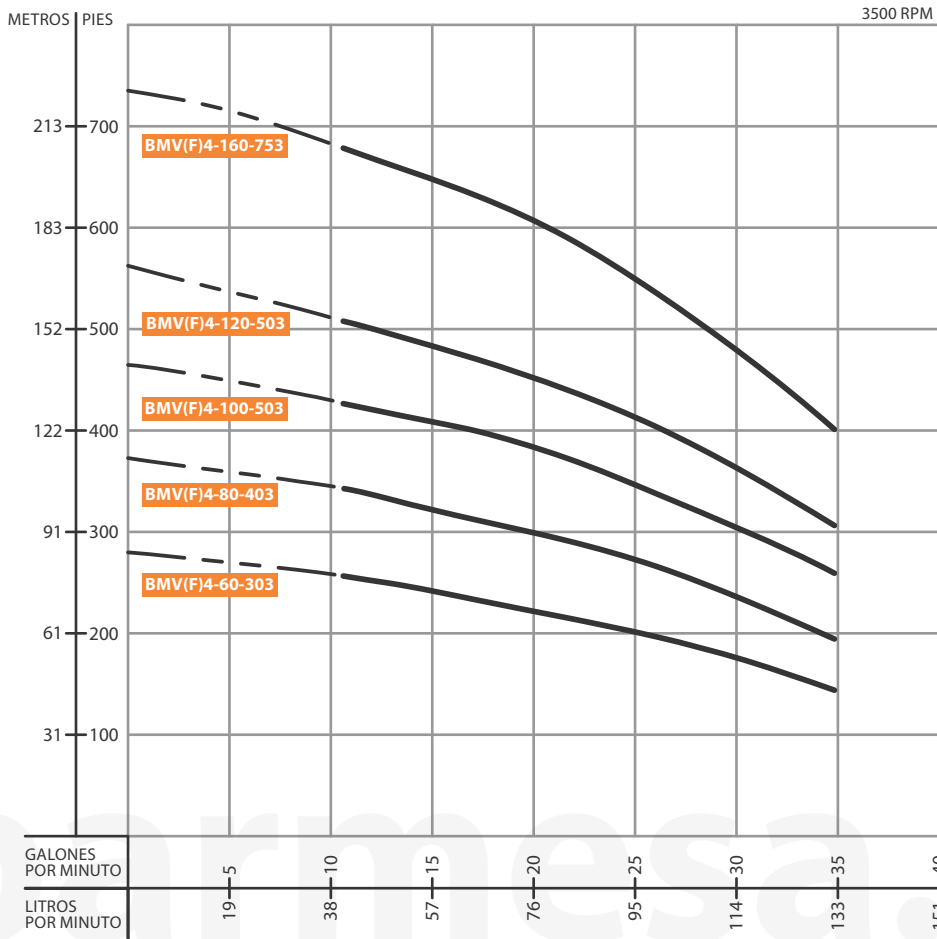

Dibujo de Instalación (mm)



Tabla de Rendimiento

| MODELO | PASOS | HP | Q (LPM) | | | | | | |
|-----------------|-------|-----|---------|-----|------|------|-----|-------|-------|
| | | | 41.7 | 50 | 66.7 | 83.3 | 100 | 116.7 | 133.3 |
| | | | H (m) | | | | | | |
| BMV(F)4-60-303 | 6 | 3 | 78 | 75 | 72 | 67 | 59 | 54 | 47 |
| BMV(F)4-80-403 | 8 | 4 | 104 | 100 | 95 | 90 | 79 | 72 | 63 |
| BMV(F)4-100-503 | 10 | 5.5 | 130 | 125 | 120 | 113 | 102 | 90 | 80 |
| BMV(F)4-120-503 | 12 | 5.5 | 156 | 150 | 145 | 136 | 122 | 109 | 96 |
| BMV(F)4-160-753 | 16 | 7.5 | 207 | 201 | 196 | 183 | 165 | 146 | 128 |

Dimensiones y Pesos

| TAMAÑO (mm) | | | | | | PESO (kg) |
|-------------|-----|-------|-----|-----|----|-----------|
| B1 | B2 | B1+B2 | D1 | D2 | | |
| 404 | 290 | 694 | 190 | 155 | 35 | |
| 468 | 345 | 813 | 197 | 165 | 42 | |
| 522 | 335 | 857 | 230 | 188 | 51 | |
| 576 | 335 | 911 | 230 | 188 | 52 | |
| 704 | 430 | 1134 | 260 | 208 | 66 | |

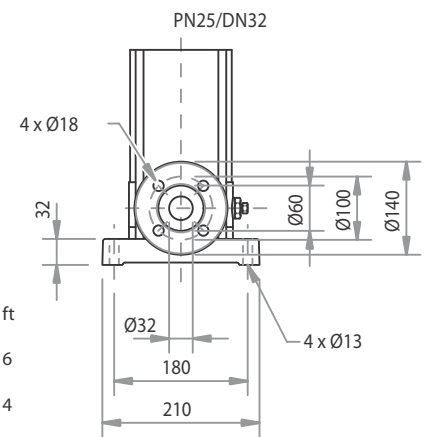
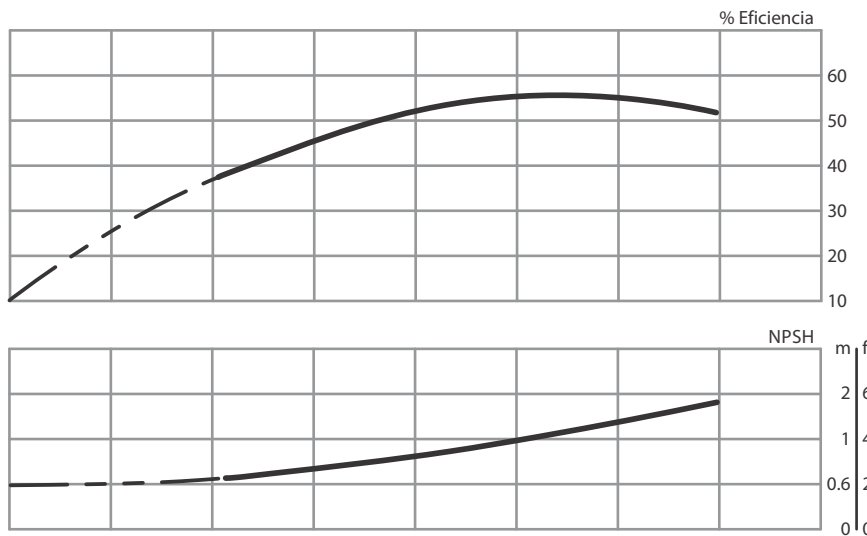
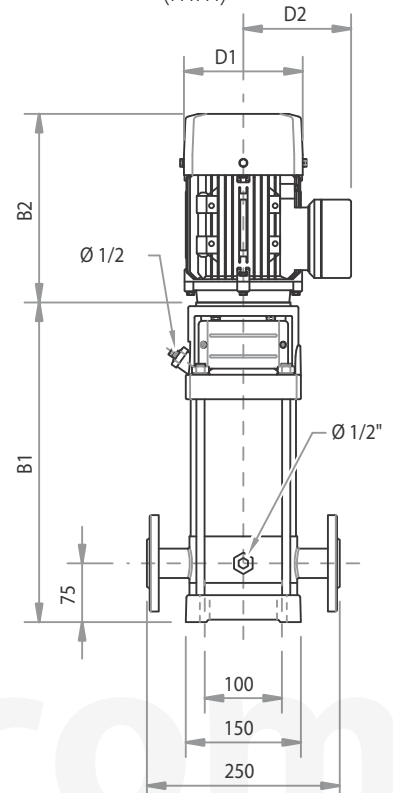
Curvas de rendimiento BMV(F)8

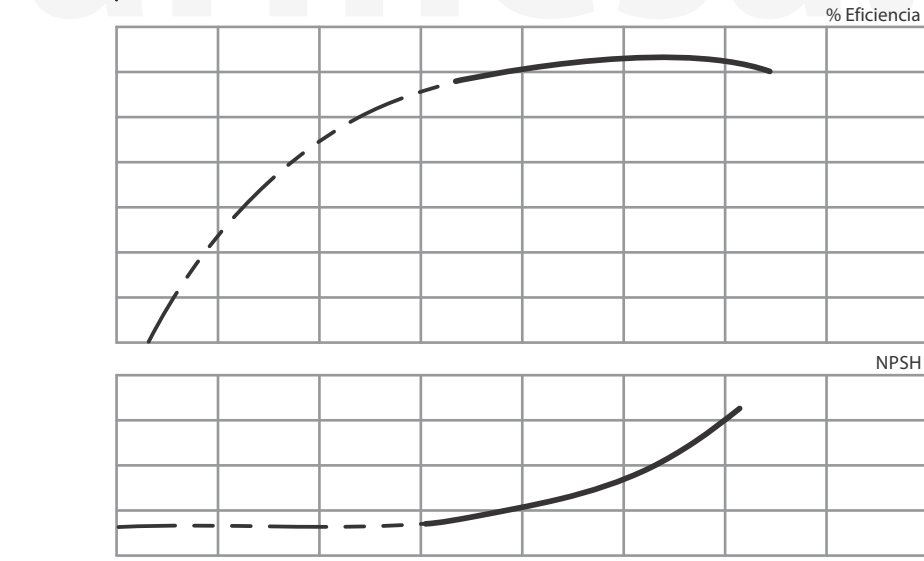
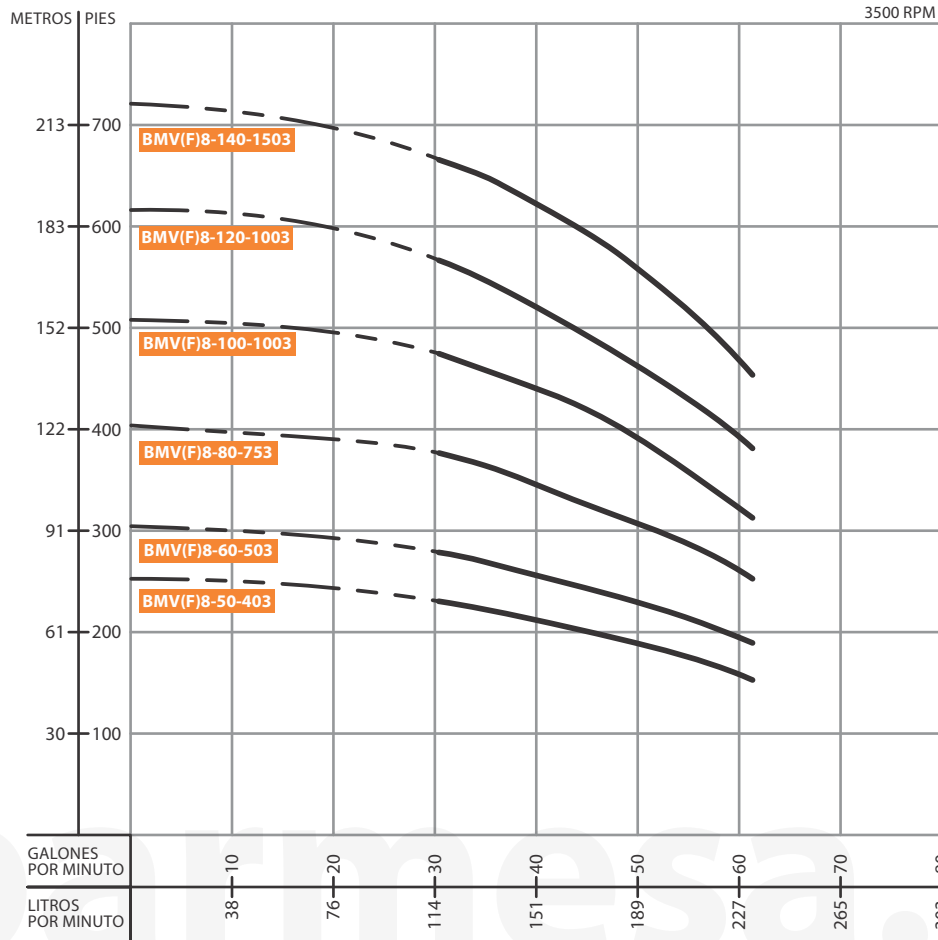

Dibujo de Instalación (mm)



Tabla de Rendimiento

| MODELO | PASOS | HP | Q (LPM) | | | | | | | |
|------------------|-------|-----|---------|-------|-----|-------|-------|-----|-------|-------|
| | | | 116.7 | 133.3 | 150 | 166.7 | 183.3 | 200 | 216.7 | 233.3 |
| | | | H (m) | | | | | | | |
| BMV(F)8-50-403 | 5 | 4 | 70 | 68 | 65 | 63 | 59 | 56 | 52 | 47 |
| BMV(F)8-60-503 | 6 | 5.5 | 85 | 82 | 78 | 76 | 72 | 68 | 62 | 57 |
| BMV(F)8-80-753 | 8 | 7.5 | 115 | 110 | 105 | 101 | 97 | 91 | 84 | 75 |
| BMV(F)8-100-1003 | 10 | 10 | 145 | 140 | 132 | 126 | 122 | 115 | 105 | 95 |
| BMV(F)8-120-1003 | 12 | 10 | 173 | 167 | 160 | 152 | 147 | 132 | 125 | 115 |
| BMV(F)8-140-1503 | 14 | 15 | 202 | 195 | 188 | 179 | 174 | 163 | 147 | 135 |

Dimensiones y Pesos

| TAMAÑO (mm) | | | | | PESO (kg) |
|-------------|-----|-------|-----|-----|-----------|
| B1 | B2 | B1+B2 | D1 | D2 | |
| 457 | 315 | 772 | 197 | 165 | 50 |
| 487 | 335 | 822 | 230 | 188 | 58 |
| 567 | 430 | 997 | 260 | 208 | 71 |
| 627 | 430 | 1057 | 260 | 208 | 80 |
| 687 | 430 | 1117 | 260 | 208 | 82 |
| 835 | 490 | 1325 | 330 | 255 | 153 |

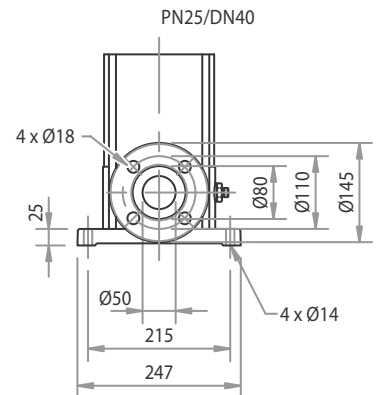
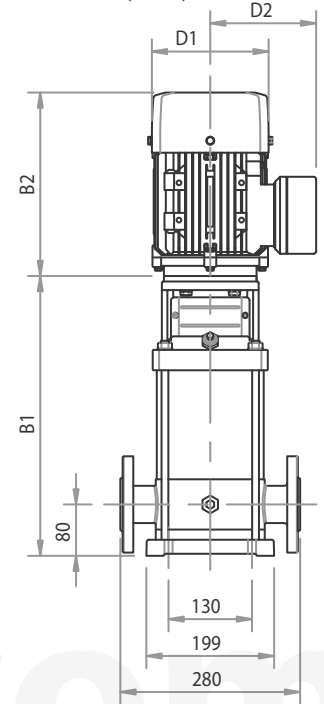
Curvas de rendimiento BMVF10



Tabla de Rendimiento

| MODELO | PASOS | HP | Q (LPM) | | | | | | |
|-----------------|-------|-----|---------|-----|-------|-------|------|-------|-------|
| | | | 116.7 | 150 | 166.7 | 183.3 | 200 | 216.7 | 250 |
| BMVF10-60-553 | 6 | 6 | 87.5 | 83 | 80 | 76 | 71.5 | 66.5 | 51.5 |
| BMVF10-90-753 | 9 | 7.5 | 132 | 125 | 120.5 | 115 | 108 | 101 | 80.5 |
| BMVF10-120-1003 | 12 | 10 | 176.5 | 167 | 161 | 154 | 144 | 135.5 | 109.5 |
| BMVF10-150-1503 | 15 | 15 | 220.5 | 209 | 202 | 193 | 180 | 170 | 137.5 |
| BMVF10-170-1503 | 17 | 15 | 249.5 | 237 | 229 | 218.5 | 204 | 192.5 | 156 |

Dimensiones y Pesos

| TAMAÑO (mm) | | | | | | PESO (kg) |
|-------------|-----|-------|-----|-----|-------|-----------|
| B1 | B2 | B1+B2 | D1 | D2 | H (m) | |
| 487 | 360 | 847 | 230 | 185 | 59 | |
| 597 | 400 | 997 | 260 | 210 | 77 | |
| 687 | 400 | 1087 | 260 | 210 | 88 | |
| 865 | 510 | 1375 | 330 | 255 | 143 | |
| 925 | 510 | 1435 | 330 | 255 | 144 | |

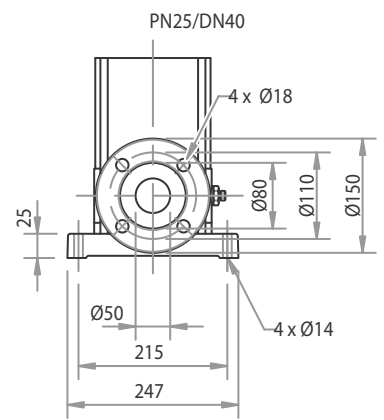
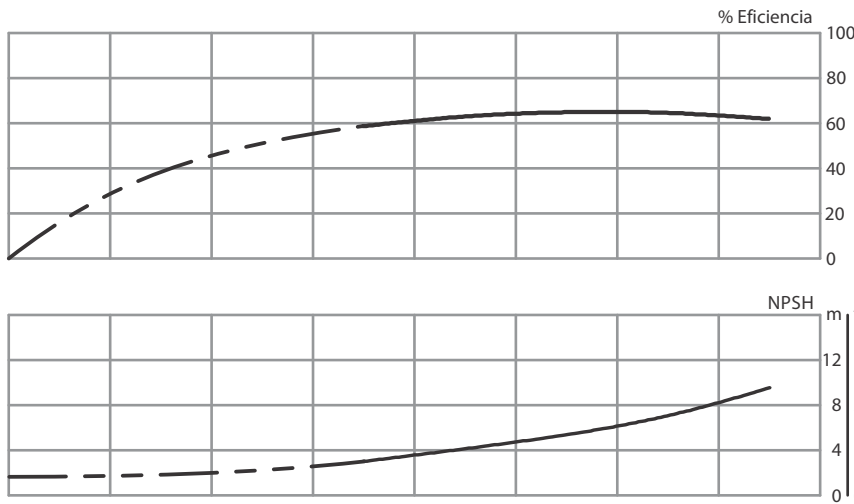
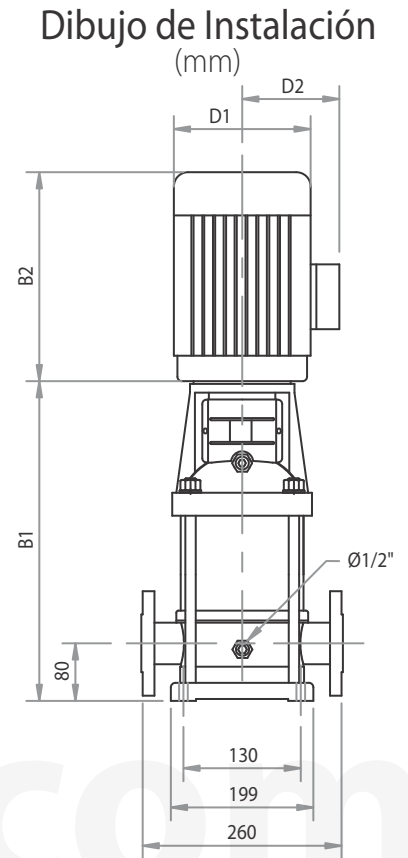
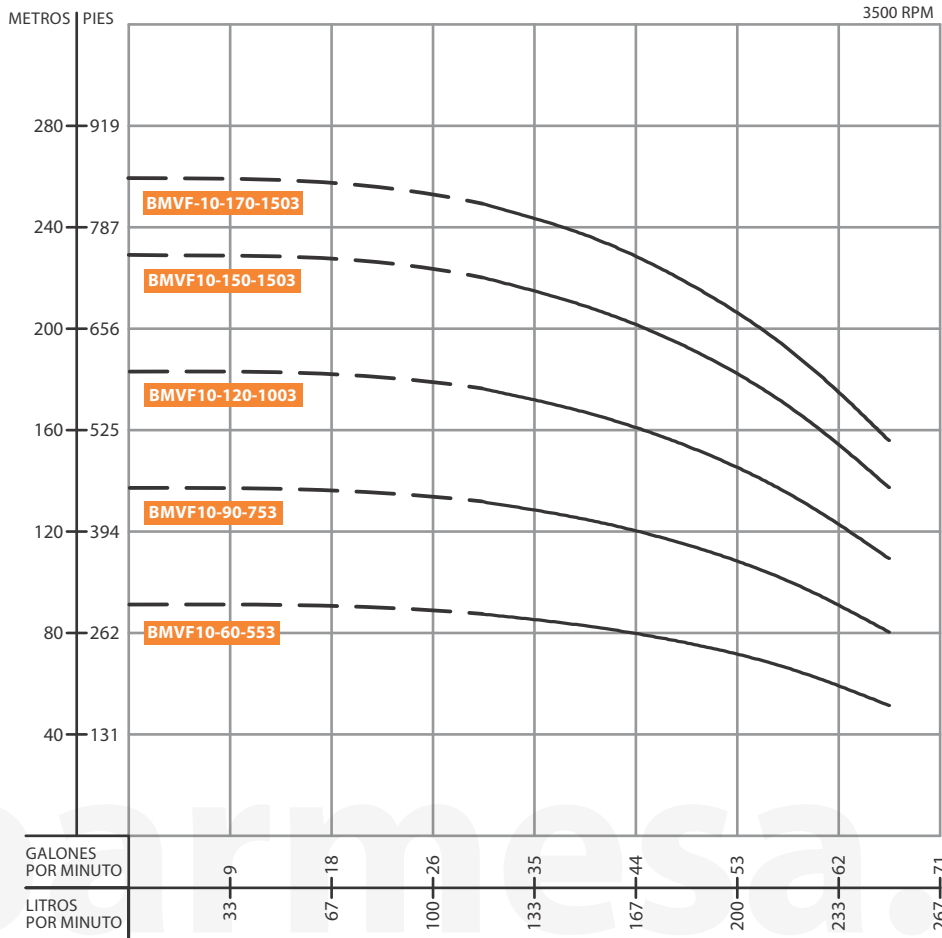
Curvas de rendimiento BMV(F)12

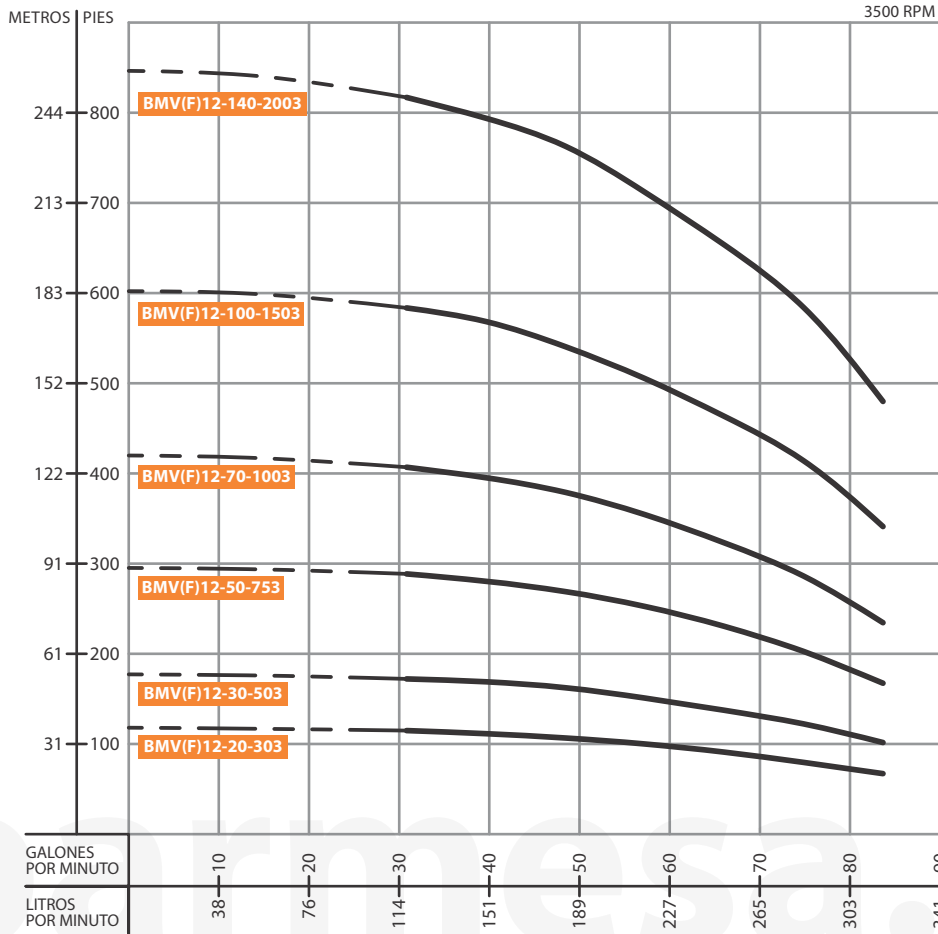

Dibujo de Instalación (mm)



Tabla de Rendimiento

| MODELO | PASOS | HP | Q (LPM) | | | | | | | |
|-------------------|-------|-----|---------|------|-------|-----|-------|------|-------|-------|
| | | | 116.7 | 150 | 183.3 | 200 | 216.7 | 250 | 283.3 | 316.7 |
| | | | H (m) | | | | | | | |
| BMV(F)12-20-303 | 2 | 3 | 35 | 34 | 32.5 | 32 | 30.5 | 27 | 24.5 | 20.5 |
| BMV(F)12-30-503 | 3 | 5.5 | 52.5 | 51.5 | 50 | 48 | 46 | 41.5 | 37.5 | 31 |
| BMV(F)12-50-753 | 5 | 7.5 | 88 | 86 | 82 | 80 | 77 | 70 | 62 | 51 |
| BMV(F)12-70-1003 | 7 | 10 | 124 | 121 | 116 | 112 | 107 | 97 | 88 | 71 |
| BMV(F)12-100-1503 | 10 | 15 | 178 | 173 | 166 | 161 | 153 | 140 | 128 | 104 |
| BMV(F)12-140-2003 | 14 | 20 | 249 | 242 | 233 | 225 | 216 | 198 | 180 | 145 |

Dimensiones y Pesos

| TAMAÑO (mm) | | | | | PESO (kg) |
|-------------|-----|-------|-----|-----|-----------|
| B1 | B2 | B1+B2 | D1 | D2 | |
| 367 | 290 | 657 | 190 | 155 | 41 |
| 407 | 335 | 742 | 230 | 188 | 56 |
| 487 | 430 | 917 | 260 | 208 | 71 |
| 547 | 430 | 977 | 260 | 208 | 78 |
| 725 | 490 | 1215 | 330 | 255 | 151 |
| 845 | 490 | 1335 | 330 | 255 | 167 |

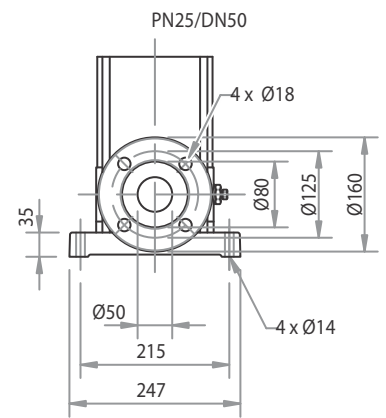
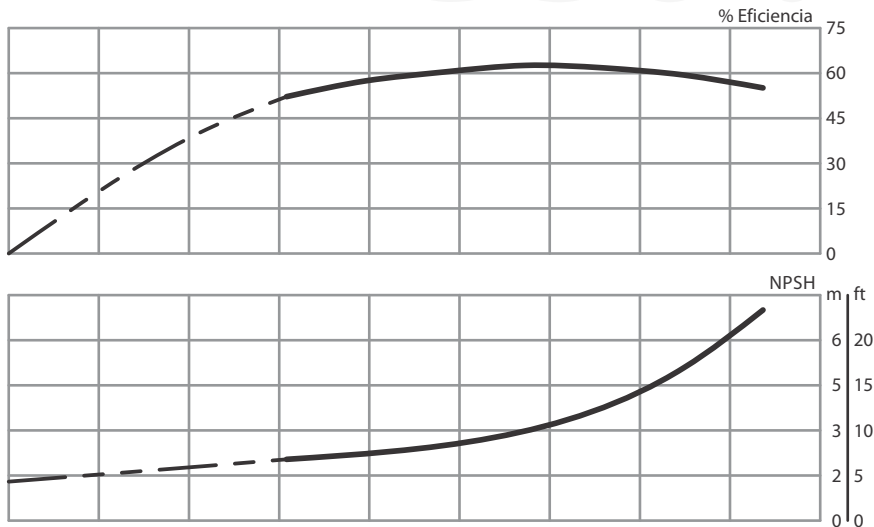
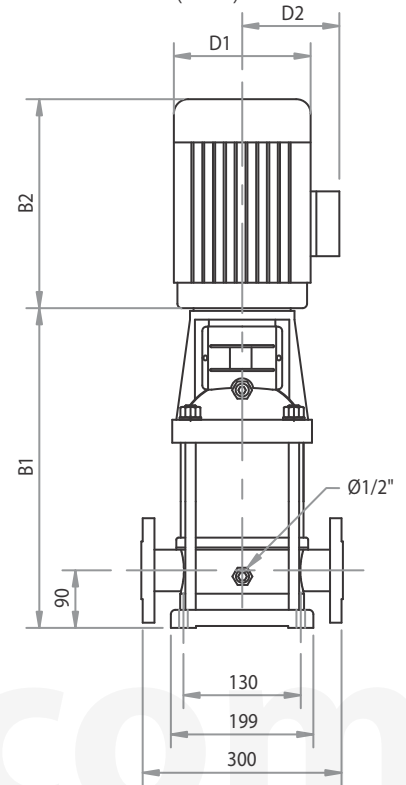
Curvas de rendimiento BMV(F)15

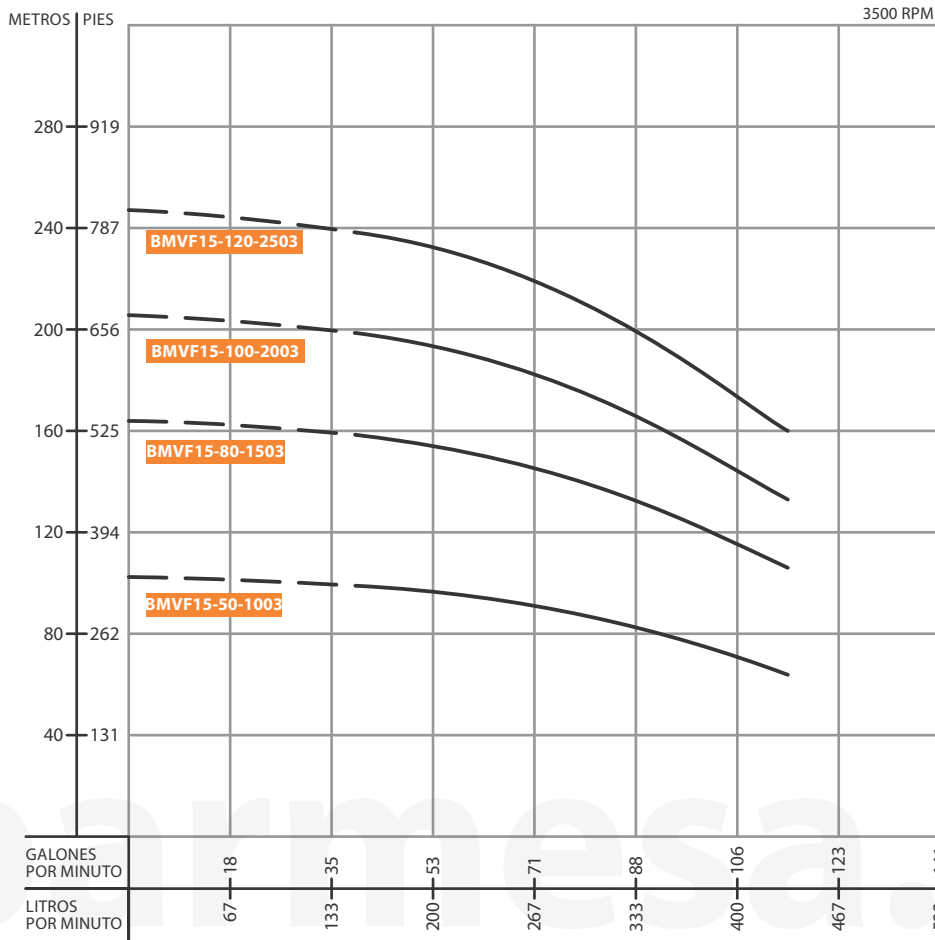

Dibujo de Instalación (mm)



Tabla de Rendimiento

| MODELO | PASOS | HP | Q (LPM) | | | | | | | | |
|-------------------|-------|----|---------|-------|-------|-------|-------|-------|-------|-------|-------|
| | | | 150 | 183.3 | 216.6 | 250 | 283.3 | 316.6 | 350 | 400 | 433.3 |
| BMV(F)15-50-1003 | 5 | 10 | 99 | 96 | 95 | 92.5 | 89.5 | 84.5 | 80 | 71 | 64 |
| BMV(F)15-80-1503 | 8 | 15 | 158.5 | 155.5 | 152.5 | 149 | 144.5 | 137 | 130 | 115.5 | 106 |
| BMV(F)15-100-2003 | 10 | 20 | 198.5 | 194.5 | 191 | 186.5 | 180.5 | 172 | 162.5 | 145 | 133 |
| BMV(F)15-120-2503 | 12 | 25 | 238 | 234 | 229.5 | 224 | 217 | 207.5 | 196 | 175 | 160 |

Dimensiones y Pesos

| TAMAÑO (mm) | | | | | PESO (kg) |
|-------------|-----|-------|-----|-----|-----------|
| B1 | B2 | B1+B2 | D1 | D2 | |
| 607 | 400 | 1007 | 260 | 210 | 82 |
| 830 | 510 | 1340 | 330 | 255 | 156 |
| 920 | 510 | 1430 | 330 | 255 | 171 |
| 1010 | 560 | 1570 | 330 | 255 | 192 |

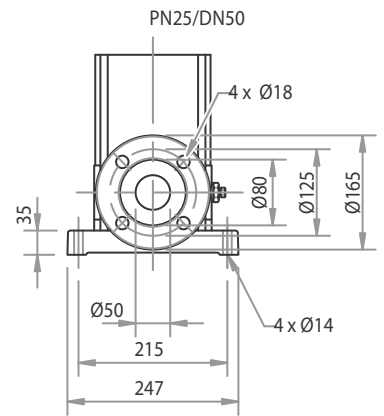
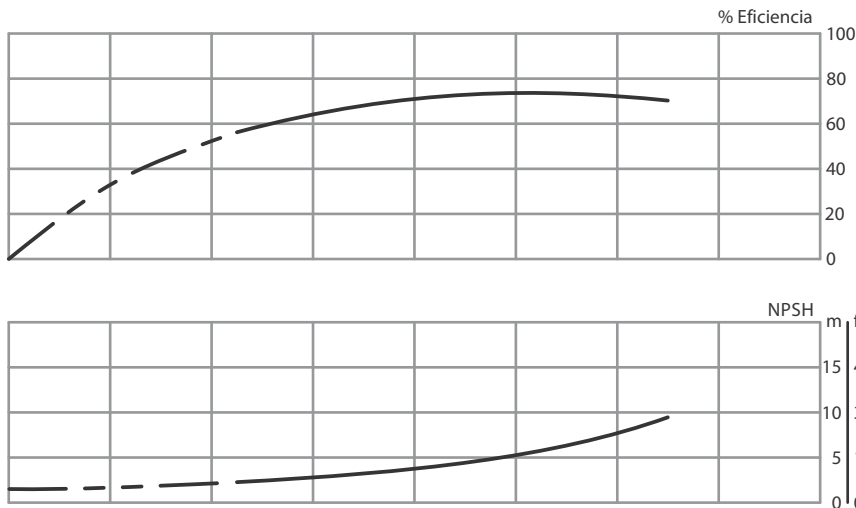
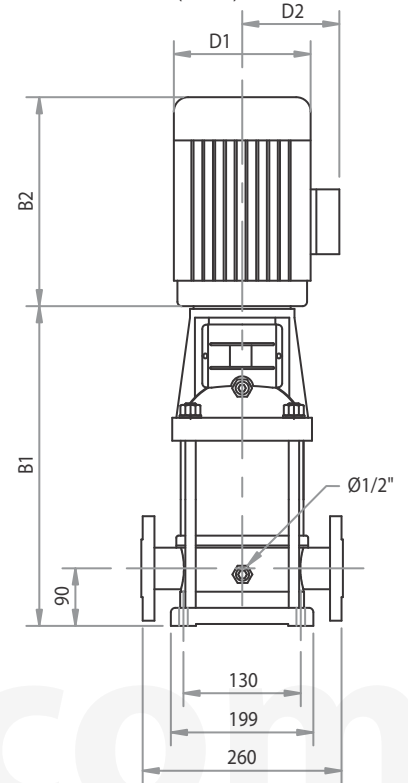
Curvas de rendimiento BMVF16

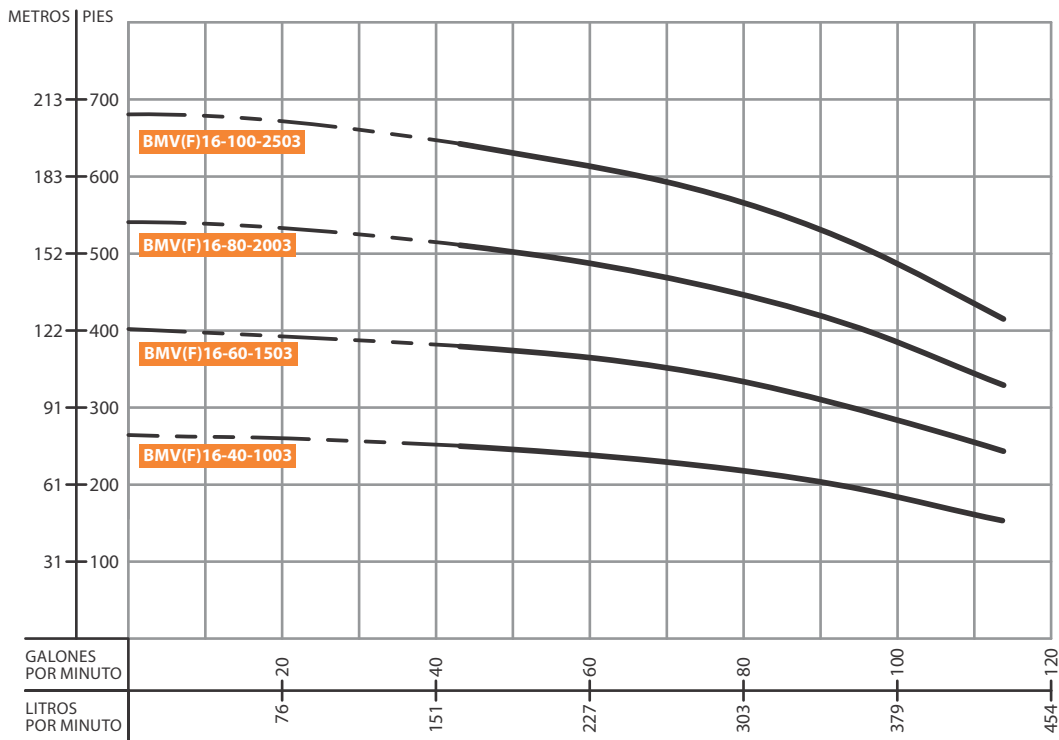

Dibujo de Instalación (mm)



Tabla de Rendimiento

| MODELO | PASOS | HP | Q (LPM) | | | | | | | | |
|-----------------|-------|----|---------|-----|-------|-------|-----|-------|-------|-----|-------|
| | | | 166.7 | 200 | 233.3 | 266.7 | 300 | 333.3 | 366.7 | 400 | 433.3 |
| BMVF16-40-1003 | 4 | 10 | 76 | 75 | 73 | 72 | 68 | 64 | 60 | 54 | 49 |
| BMVF16-60-1503 | 6 | 15 | 115 | 113 | 111 | 108 | 102 | 96 | 91 | 82 | 75 |
| BMVF16-80-2003 | 8 | 20 | 155 | 152 | 148 | 144 | 137 | 130 | 122 | 111 | 101 |
| BMVF16-100-2503 | 10 | 25 | 197 | 192 | 187 | 181 | 174 | 165 | 153 | 139 | 127 |

Dimensiones y Pesos

| TAMAÑO (mm) | | | | | PESO (kg) |
|-------------|-----|-------|-----|-----|-----------|
| B1 | B2 | B1+B2 | D1 | D2 | |
| 517 | 430 | 947 | 260 | 208 | 75 |
| 695 | 490 | 1185 | 330 | 255 | 150 |
| 785 | 490 | 1275 | 330 | 255 | 163 |
| 875 | 550 | 1425 | 330 | 255 | 186 |

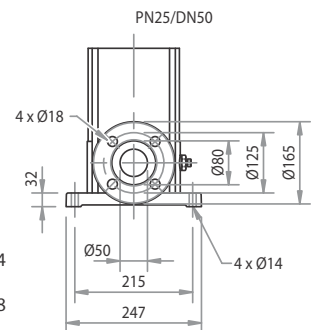
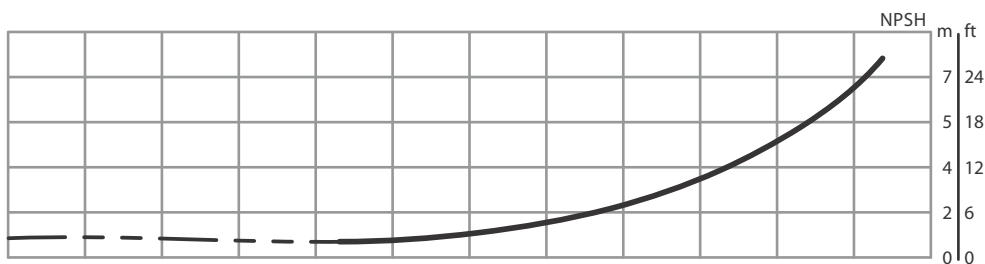
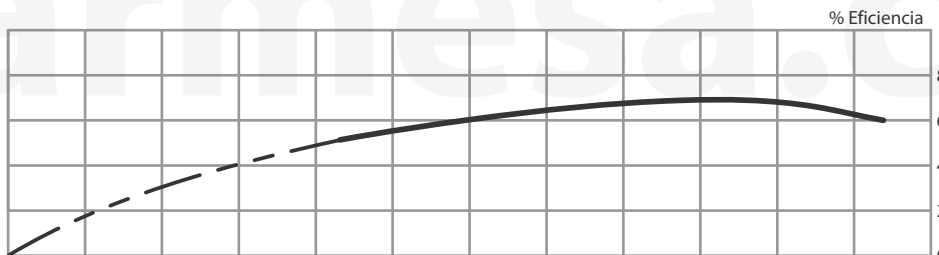
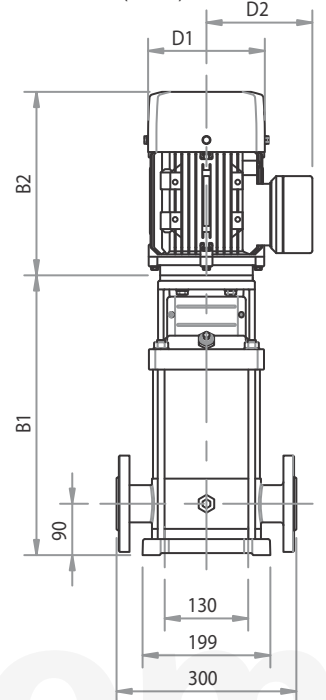
Curvas de rendimiento BMV(F)20

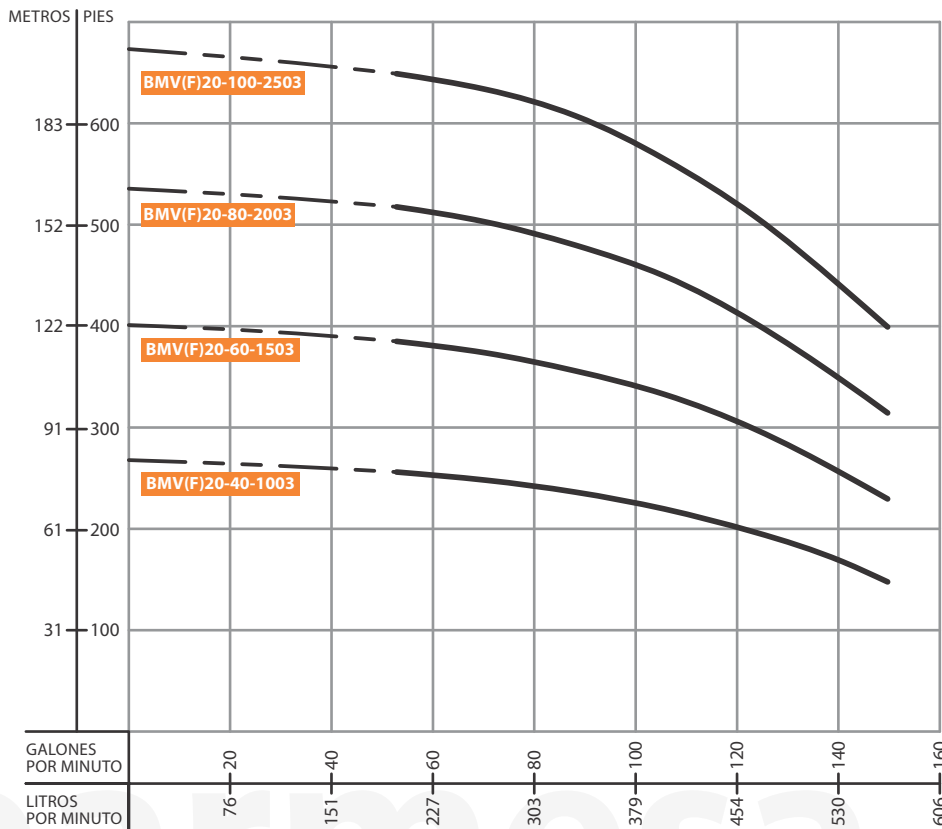

Dibujo de Instalación (mm)



Tabla de Rendimiento

| MODELO | PASOS | HP | Q (LPM) | | | | | | |
|-------------------|-------|----|---------|-------|-------|-----|-------|-------|-------|
| | | | 200 | 266.7 | 333.3 | 400 | 466.7 | 533.3 | 566.7 |
| | | | H (m) | | | | | | |
| BMV(F)20-40-1003 | 4 | 10 | 78 | 75 | 72 | 67 | 60 | 51 | 45 |
| BMV(F)20-60-1503 | 6 | 15 | 118 | 113 | 108 | 102 | 91 | 77 | 70 |
| BMV(F)20-80-2003 | 8 | 20 | 158 | 153 | 146 | 137 | 123 | 105 | 96 |
| BMV(F)20-100-2503 | 10 | 25 | 198 | 193 | 185 | 172 | 155 | 133 | 122 |

Dimensiones y Pesos

| TAMAÑO (mm) | | | | | | PESO (kg) |
|-------------|-----|-------|-----|-----|-----|-----------|
| B1 | B2 | B1+B2 | D1 | D2 | | |
| 517 | 430 | 947 | 260 | 208 | 79 | |
| 695 | 490 | 1185 | 330 | 255 | 150 | |
| 785 | 490 | 1275 | 330 | 255 | 163 | |
| 875 | 550 | 1425 | 330 | 255 | 187 | |

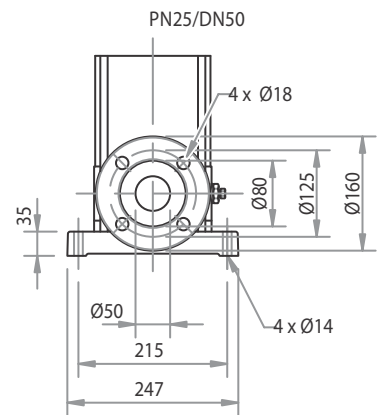
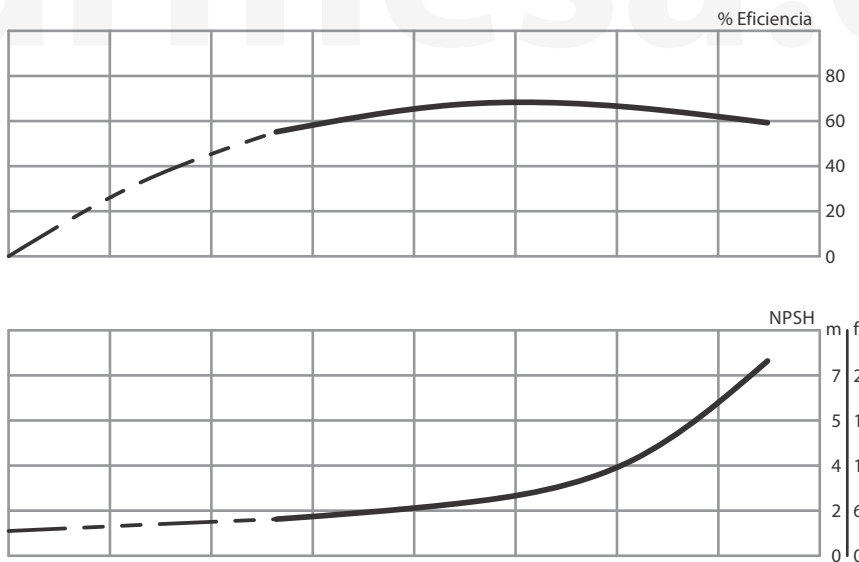
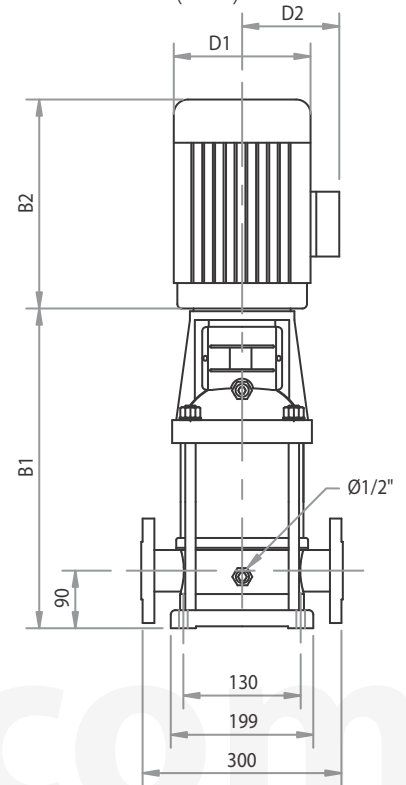
Curvas de rendimiento BMV(F)32

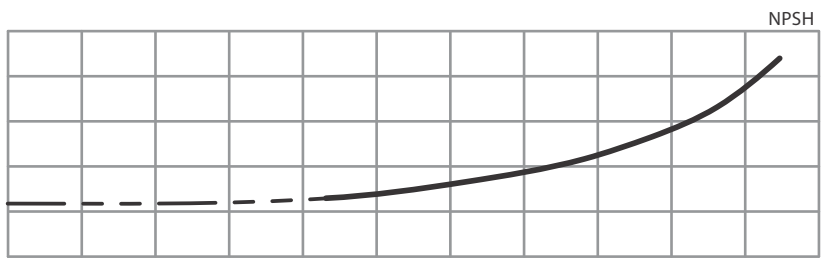
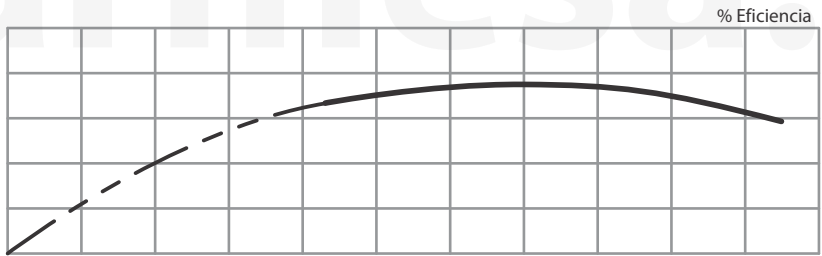
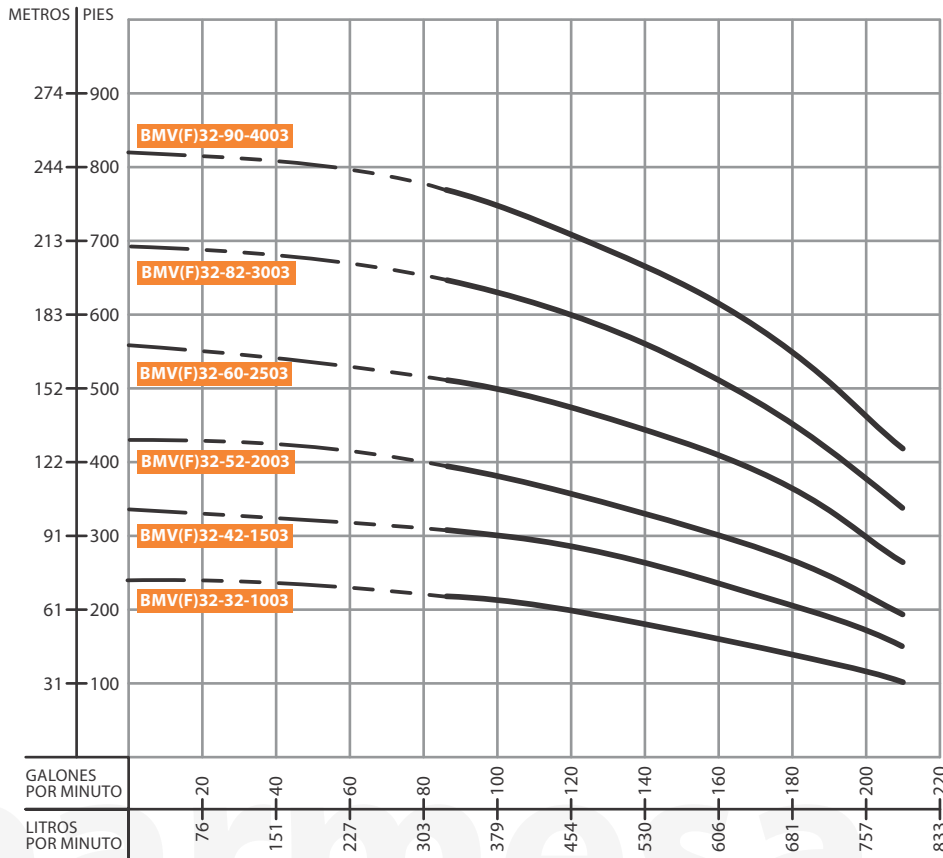

Dibujo de Instalación (mm)



Tabla de Rendimiento

| MODELO | PASOS | HP | Q (LPM) | | | | | | | |
|------------------|-------|----|---------|-----|-------|-------|-----|-------|-------|-----|
| | | | 333.3 | 400 | 466.7 | 533.3 | 600 | 666.7 | 733.3 | 800 |
| BMV(F)32-32-1003 | 3 | 10 | 67 | 64 | 61 | 57 | 52 | 46 | 39 | 31 |
| BMV(F)32-42-1503 | 4 | 15 | 94 | 91 | 87 | 81 | 73 | 65 | 56 | 45 |
| BMV(F)32-52-2003 | 5 | 20 | 119 | 115 | 109 | 102 | 94 | 84 | 73 | 59 |
| BMV(F)32-60-2503 | 6 | 25 | 155 | 150 | 144 | 136 | 126 | 114 | 100 | 81 |
| BMV(F)32-82-3003 | 8 | 30 | 196 | 190 | 182 | 172 | 159 | 143 | 124 | 102 |
| BMV(F)32-90-4003 | 9 | 40 | 234 | 226 | 216 | 204 | 189 | 172 | 152 | 127 |

Dimensiones y Pesos

| B1 | B2 | B1+B2 | TAMAÑO (mm) | | | PESO (kg) |
|------|-----|-------|-------------|-----|-----|-----------|
| | | | D1 | D2 | | |
| 645 | 490 | 1135 | 330 | 255 | 104 | |
| 820 | 490 | 1310 | 330 | 255 | 176 | |
| 890 | 490 | 1380 | 330 | 255 | 191 | |
| 960 | 550 | 1510 | 330 | 255 | 216 | |
| 1100 | 590 | 1690 | 400 | 310 | 259 | |
| 1170 | 660 | 1830 | 400 | 310 | 319 | |

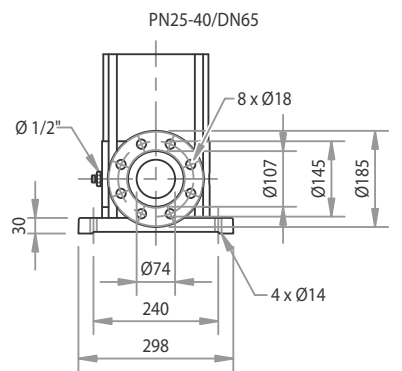
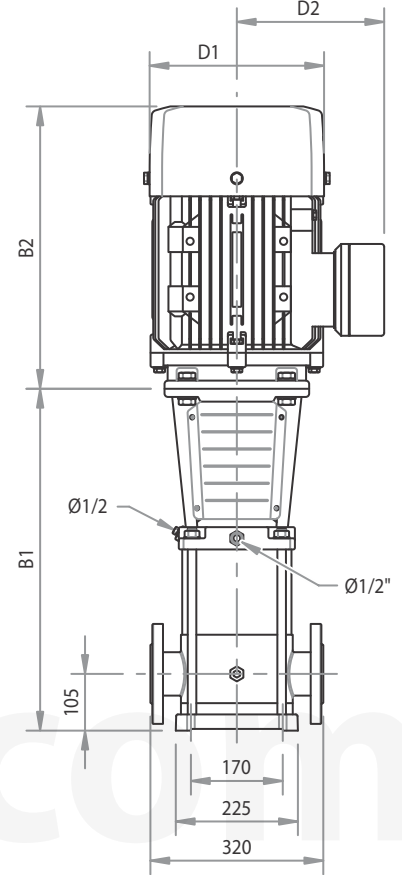
Curvas de rendimiento BMV(F)42

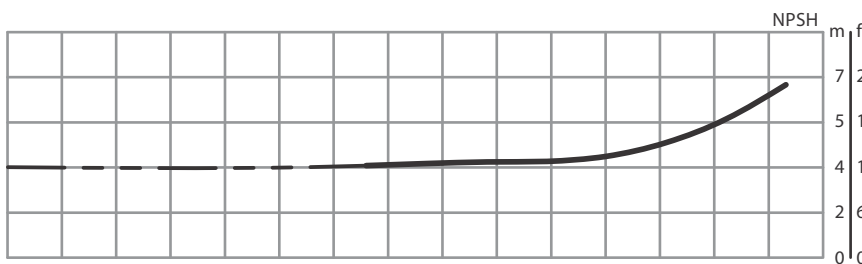
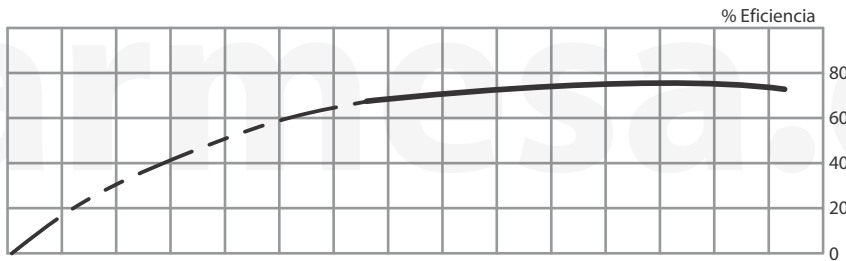
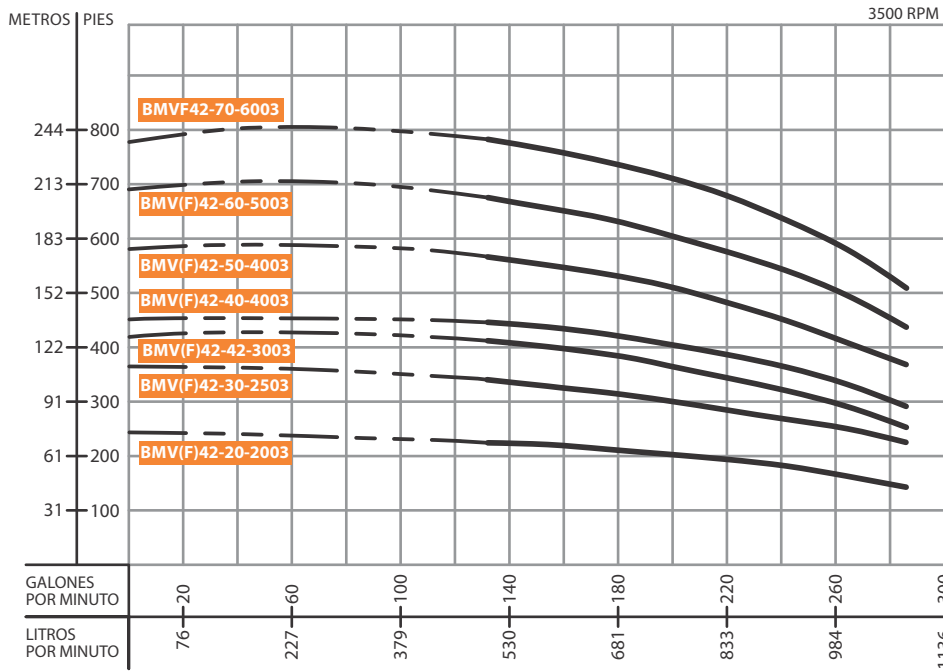

Dibujo de Instalación (mm)



Tabla de Rendimiento

| MODELO | PASOS | HP | Q (LPM) | | | | | | | |
|------------------|-------|----|---------|-------|-------|-----|-------|-------|------|--------|
| | | | 500 | 583.3 | 666.7 | 750 | 833.3 | 916.7 | 1000 | 1083.3 |
| | | | H (m) | | | | | | | |
| BMV(F)42-20-2003 | 2 | 20 | 69 | 67 | 65 | 61 | 59 | 55 | 50 | 44 |
| BMV(F)42-30-2503 | 3 | 25 | 102 | 100 | 97 | 92 | 88 | 82 | 76 | 68 |
| BMV(F)42-42-3003 | 4 | 30 | 125 | 121 | 118 | 112 | 105 | 98 | 89 | 78 |
| BMV(F)42-40-4003 | 4 | 40 | 136 | 133 | 129 | 123 | 117 | 112 | 102 | 89 |
| BMV(F)42-50-4003 | 5 | 40 | 171 | 166 | 161 | 154 | 145 | 138 | 126 | 112 |
| BMV(F)42-60-5003 | 6 | 50 | 205 | 200 | 193 | 186 | 176 | 166 | 152 | 134 |
| BMVF42-70-6003 | 7 | 60 | 239 | 232 | 226 | 216 | 204 | 194 | 178 | 157 |

Dimensiones y Pesos

| B1 | B2 | B1+B2 | TAMAÑO (mm) | | PESO (kg) |
|------|-----|-------|-------------|-----|-----------|
| | | | D1 | D2 | |
| 748 | 490 | 1238 | 330 | 255 | 188 |
| 828 | 550 | 1378 | 330 | 255 | 213 |
| 908 | 590 | 1498 | 360 | 285 | 253 |
| 908 | 660 | 1568 | 400 | 310 | 309 |
| 988 | 660 | 1648 | 400 | 310 | 313 |
| 1068 | 660 | 1728 | 400 | 310 | 340 |
| 1148 | 700 | 1848 | 460 | 340 | 404 |

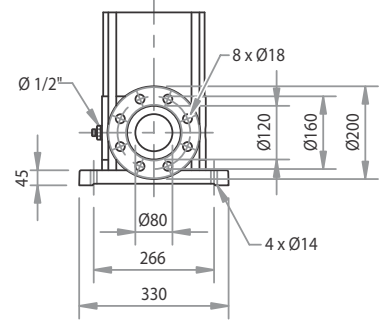
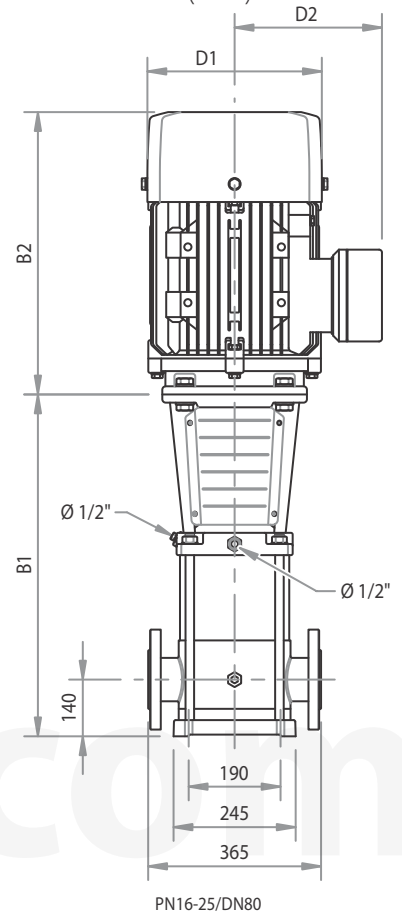
Curvas de rendimiento BMV(F)65

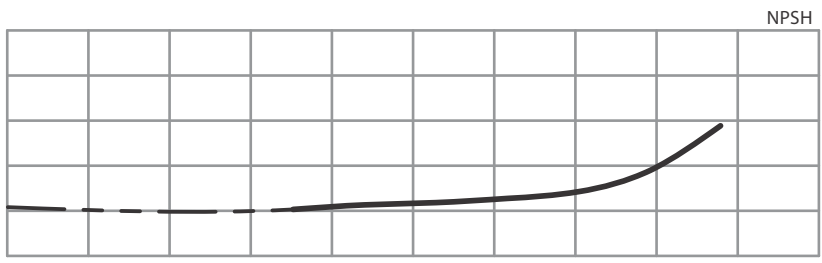
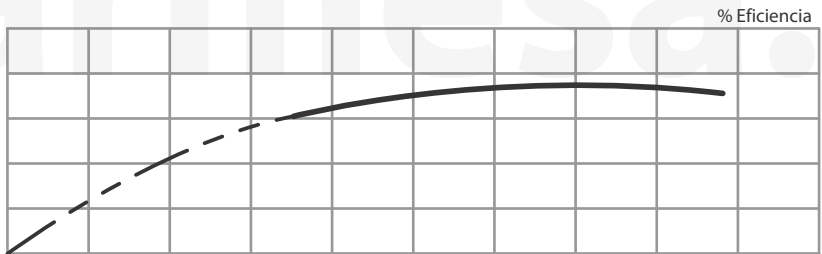
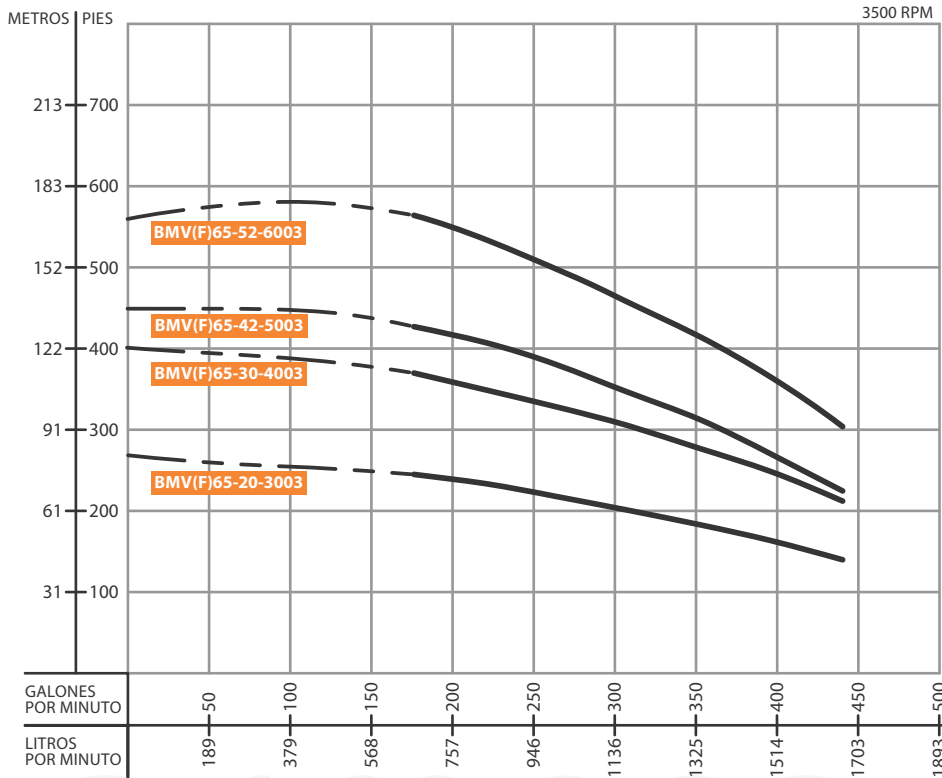

Dibujo de Instalación (mm)



Tabla de Rendimiento

| MODELO | PASOS | HP | Q (LPM) | | | | | | | |
|------------------|-------|----|---------|-------|------|--------|--------|--------|------|--------|
| | | | 666.7 | 833.3 | 1000 | 1083.3 | 1166.7 | 1333.3 | 1500 | 1666.7 |
| BMV(F)65-20-3003 | 2 | 30 | 74 | 72 | 67 | 64 | 62 | 57 | 51 | 42 |
| BMV(F)65-30-4003 | 3 | 40 | 112 | 108 | 100 | 96 | 93 | 86 | 77 | 65 |
| BMV(F)65-42-5003 | 4 | 50 | 130 | 124 | 115 | 110 | 103 | 94 | 83 | 66 |
| BMV(F)65-52-6003 | 5 | 60 | 172 | 162 | 151 | 144 | 137 | 126 | 112 | 91 |

Dimensiones y Pesos

| B1 | B2 | B1+B2 | TAMAÑO (mm) | | PESO (kg) |
|------|-----|-------|-------------|-----|-----------|
| | | | D1 | D2 | |
| 754 | 590 | 1344 | 360 | 285 | 248 |
| 836 | 660 | 1496 | 400 | 310 | 313 |
| 919 | 660 | 1579 | 400 | 310 | 336 |
| 1001 | 700 | 1701 | 460 | 340 | 402 |

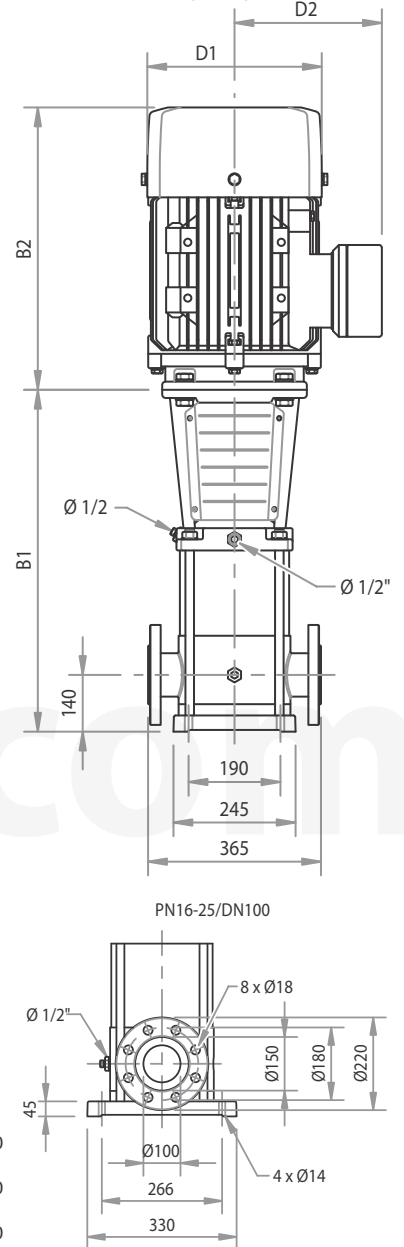
Curvas de rendimiento BMVF90

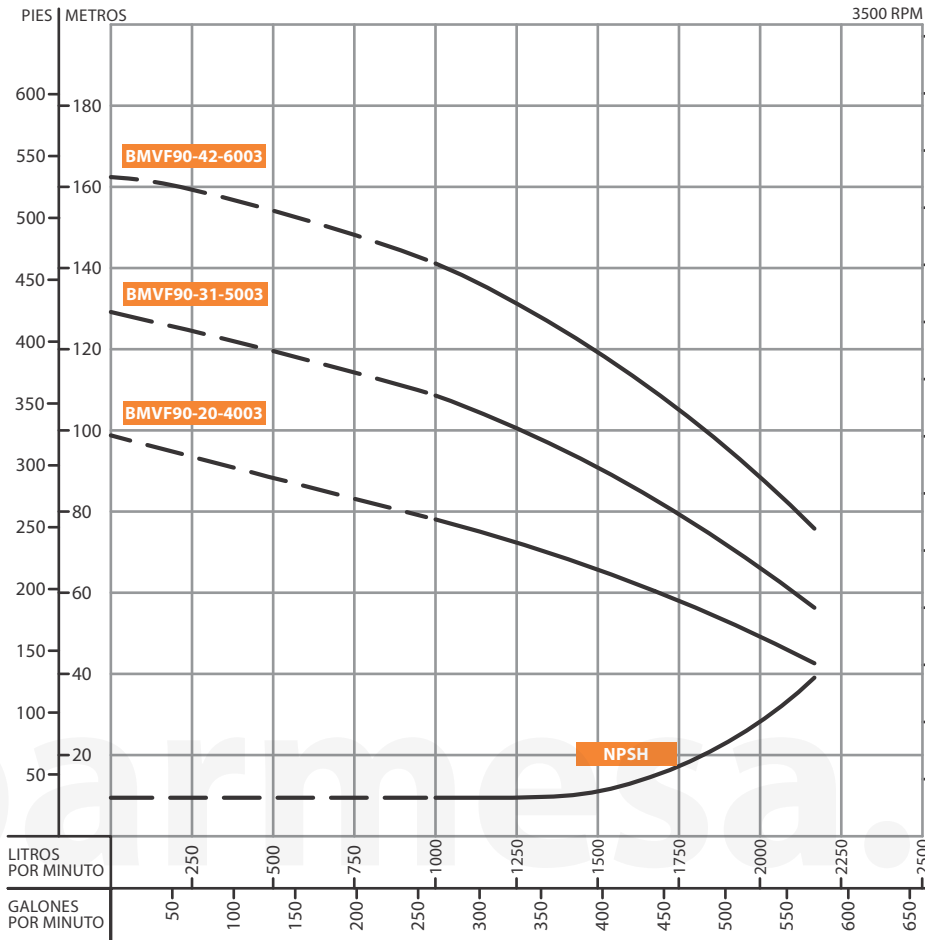

Dibujo de Instalación (mm)



Tabla de Rendimiento

| MODELO | PASOS | HP | Q (LPM) | | | | | | | |
|----------------|-------|----|---------|--------|--------|------|--------|--------|------|--------|
| | | | 1000 | 1166.6 | 1333.3 | 1500 | 1666.6 | 1833.3 | 2000 | 2166.6 |
| BMVF90-20-4003 | 2 | 40 | 76 | 73 | 69 | 64 | 60 | 56 | 52 | 44 |
| BMVF90-31-5003 | 3 | 50 | 108 | 104 | 98 | 90 | 83 | 78 | 69 | 56 |
| BMVF90-42-6003 | 4 | 60 | 141 | 135 | 128 | 118 | 109 | 102 | 89 | 72 |

Dimensiones y Pesos

| TAMAÑO (mm) | | | | | PESO (kg) |
|-------------|-----|-------|-----|-----|-----------|
| B1 | B2 | B1+B2 | D1 | D2 | |
| 773 | 660 | 1433 | 400 | 310 | 304 |
| 865 | 660 | 1525 | 400 | 310 | 330 |
| 957 | 700 | 1657 | 460 | 340 | 396 |

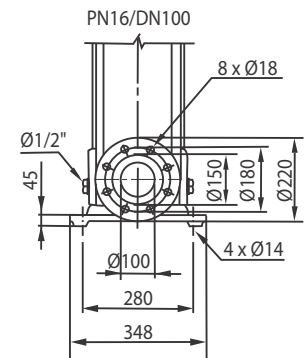
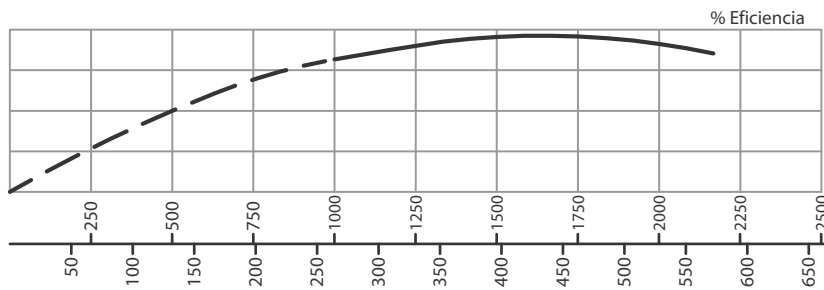
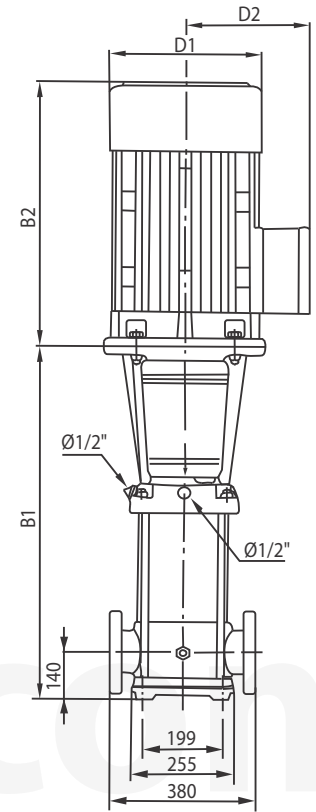
Curvas de rendimiento BMVF120

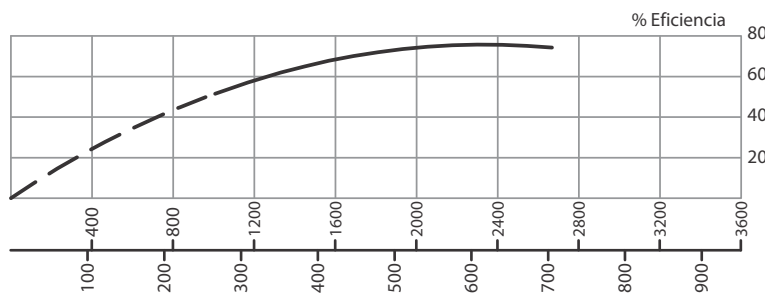
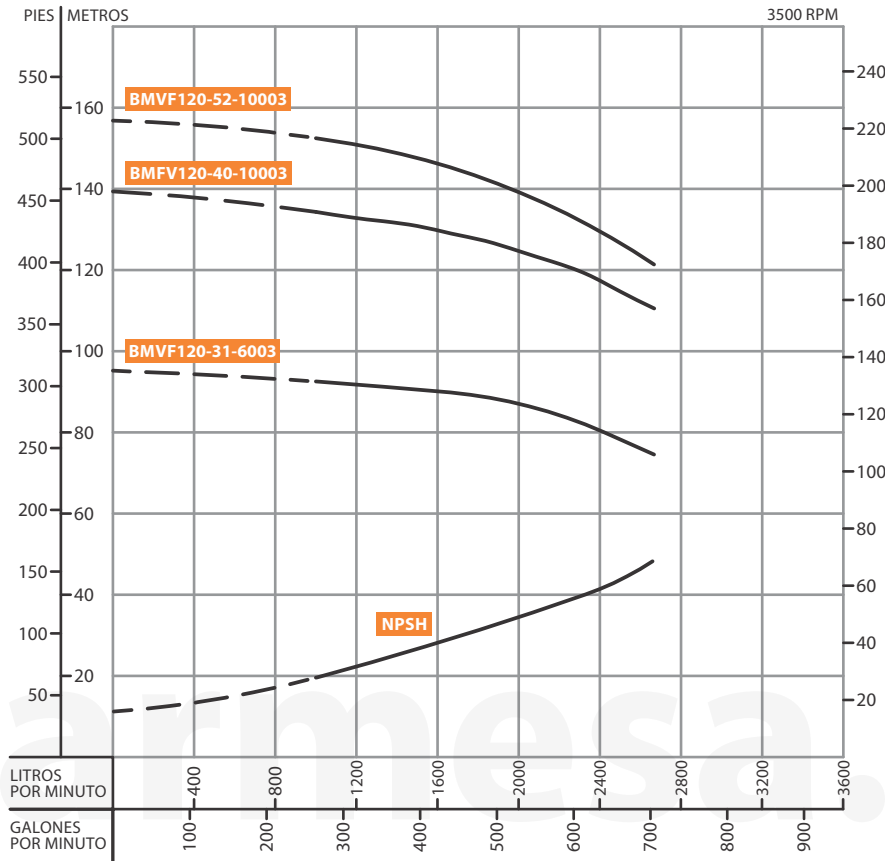

Dibujo de Instalación (mm)

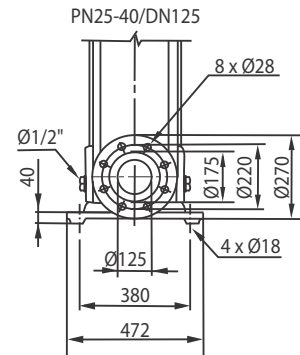
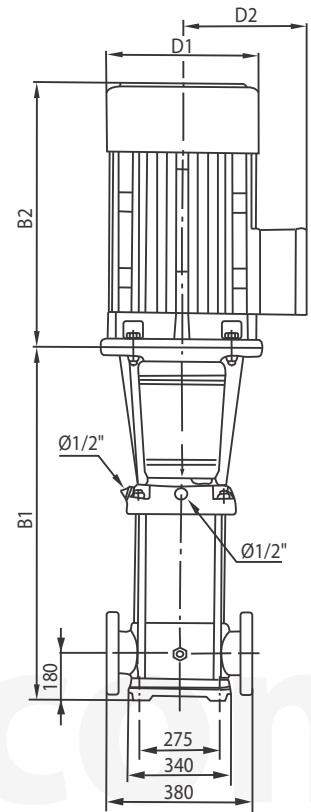

Dimensiones y Pesos

| TAMAÑO (mm) | | | | | PESO (kg) |
|-------------|-----|-------|-----|-----|-----------|
| B1 | B2 | B1+B2 | D1 | D2 | |
| 1160 | 700 | 1860 | 460 | 340 | 445 |
| 1350 | 845 | 2195 | 580 | 410 | 675 |
| 1510 | 845 | 2355 | 580 | 410 | 690 |

Tabla de Rendimiento

| MODELO | PASOS | HP | Q (LPM) | | | | | | | | | | |
|------------------|-------|-----|---------|--------|--------|------|--------|--------|------|--------|--------|-------|--------|
| | | | 1000 | 1166.6 | 1333.3 | 1500 | 1666.6 | 1833.3 | 2000 | 2166.6 | 2333.3 | 2500 | 2666.6 |
| BMVF120-31-6003 | 3 | 60 | 91.3 | 91 | 90.4 | 89 | 87.7 | 86 | 84.4 | 82 | 80 | 76.7 | 73.3 |
| BMVF120-40-10003 | 4 | 100 | 134 | 133 | 132 | 131 | 129.5 | 127.5 | 125 | 122 | 119 | 114.5 | 109.5 |
| BMVF120-52-10003 | 5 | 100 | 152 | 151 | 149.7 | 147 | 144 | 141.5 | 139 | 135.5 | 132 | 127 | 122 |

Curvas de rendimiento BMVF150

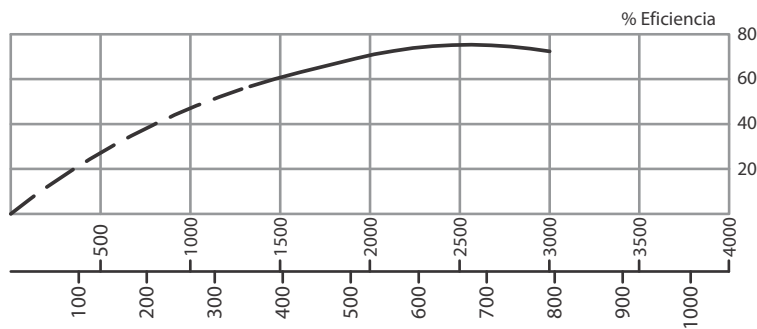
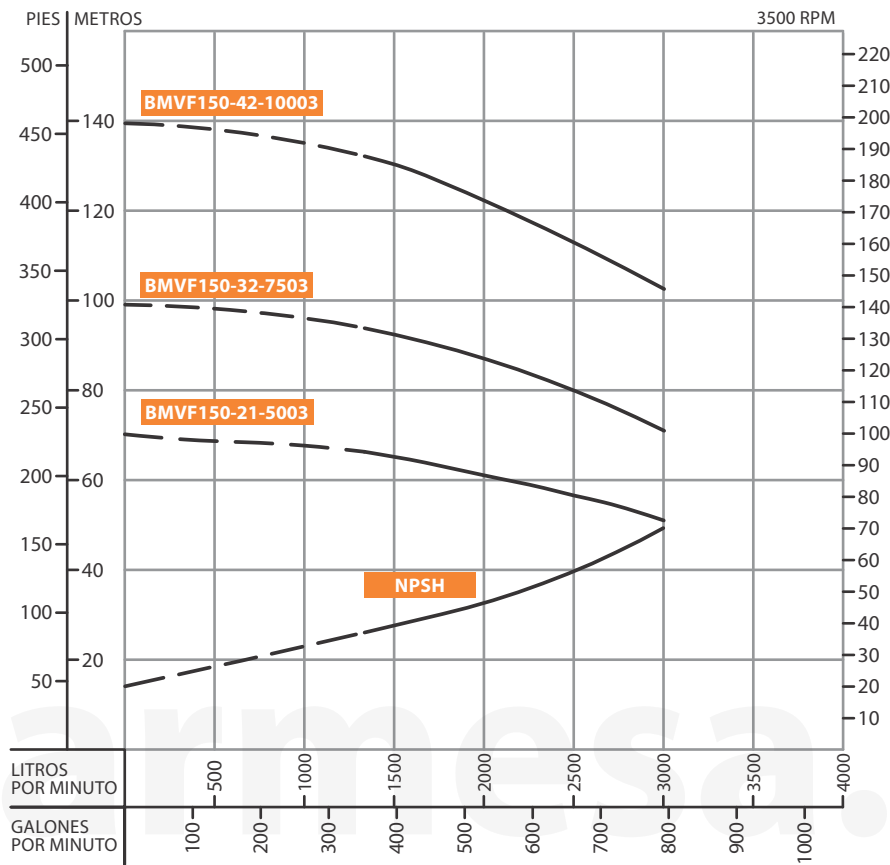

Dibujo de Instalación (mm)

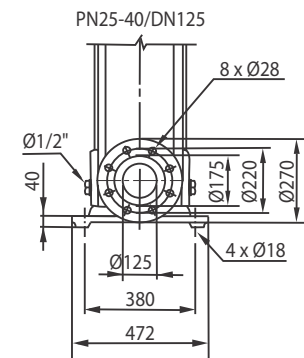
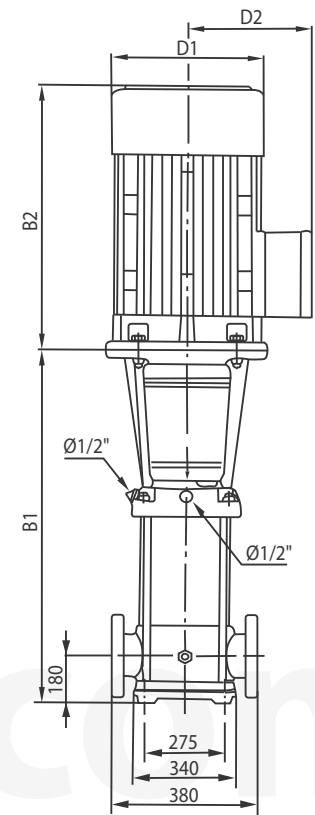

Dimensiones y Pesos

| TAMAÑO (mm) | | | | | PESO (kg) |
|-------------|-----|-------|-----|-----|-----------|
| B1 | B2 | B1+B2 | D1 | D2 | |
| 1000 | 660 | 1660 | 400 | 310 | 380 |
| 1190 | 770 | 1960 | 510 | 370 | 545 |
| 1350 | 845 | 2195 | 580 | 410 | 680 |

Tabla de Rendimiento

| MODELO | PASOS | HP | Q (LPM) | | | | | | | | | | |
|------------------|-------|-----|---------|-------|--------|--------|-------|--------|--------|-------|--------|--------|-------|
| | | | 1333.3 | 1500 | 1666.6 | 1833.3 | 2000 | 2166.6 | 2333.3 | 2500 | 2666.6 | 2833.3 | 3000 |
| BMVF150-21-5003 | 2 | 50 | 67 | 65 | 63.5 | 62 | 61 | 60 | 58.5 | 56 | 55 | 53 | 51 |
| BMVF150-32-7503 | 3 | 75 | 94 | 92 | 90.5 | 88.4 | 86.4 | 83.8 | 81 | 80 | 78 | 75.3 | 72.5 |
| BMVF150-42-10003 | 4 | 100 | 133 | 130.3 | 127.6 | 124.6 | 121.7 | 118.3 | 115 | 112.5 | 110 | 106.3 | 102.5 |

Curvas de rendimiento BMVF200

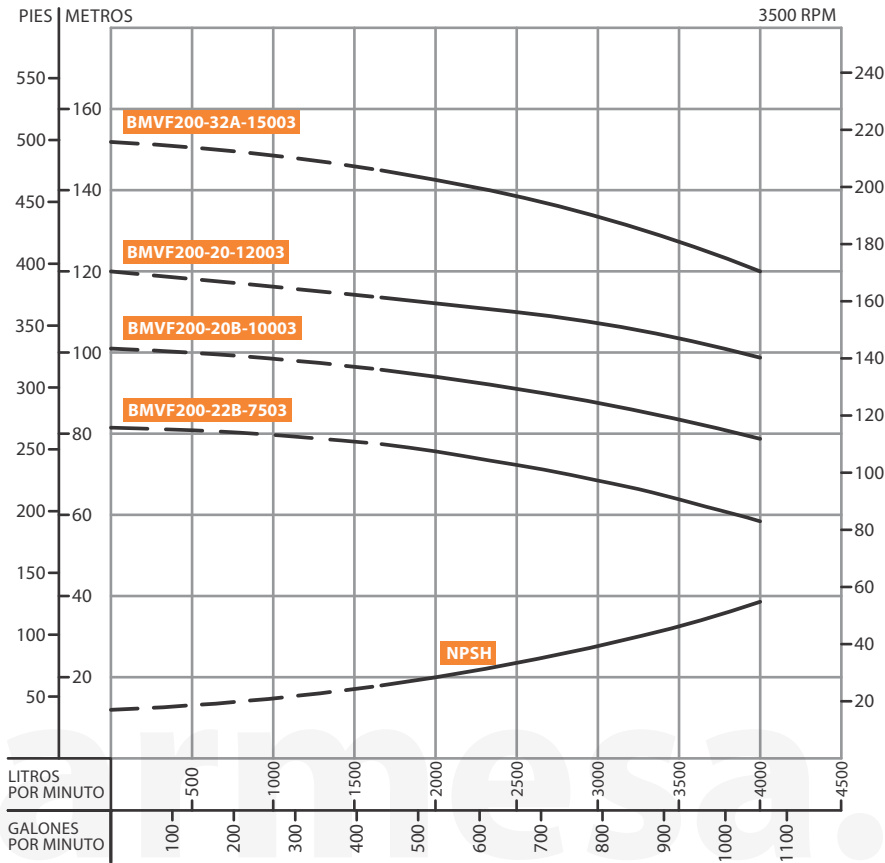

Dibujo de Instalación (mm)



Tabla de Rendimiento

| MODELO | PASOS | HP | Q (LPM) | | | | | | | |
|-------------------|-------|-----|---------|-------|--------|--------|-------|--------|--------|------|
| | | | 1666.6 | 2000 | 2333.3 | 2666.6 | 3000 | 3333.3 | 3666.6 | 4000 |
| BMVF200-22B-7503 | 2 | 75 | 77.5 | 75.5 | 73.5 | 71 | 68.5 | 66 | 62 | 58.5 |
| BMVF200-20B-10003 | 2 | 100 | 95.5 | 93.5 | 92.5 | 90.5 | 88.5 | 86 | 82.5 | 79 |
| BMVF200-20-12003 | 2 | 120 | 114 | 112.5 | 111 | 109.5 | 107.5 | 105 | 101.5 | 98.5 |
| BMVF200-32A-15003 | 3 | 150 | 145 | 142.5 | 140 | 137 | 133.5 | 130 | 125.5 | 120 |

Dimensiones y Pesos

| B1 | B2 | B1+B2 | TAMAÑO (mm) | | PESO (kg) |
|------|------|-------|-------------|-----|-----------|
| | | | D1 | D2 | |
| 1131 | 770 | 1901 | 540 | 370 | 595 |
| 1131 | 845 | 1976 | 580 | 410 | 718 |
| 1131 | 895 | 2026 | 580 | 410 | 787 |
| 1325 | 1140 | 2465 | 645 | 550 | 1158 |

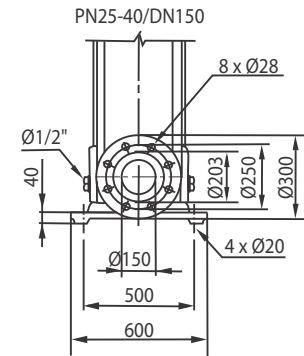
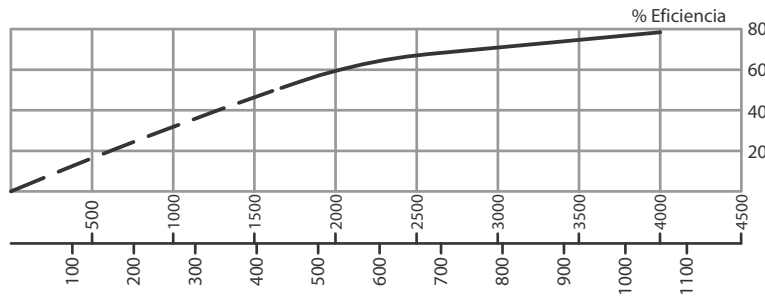
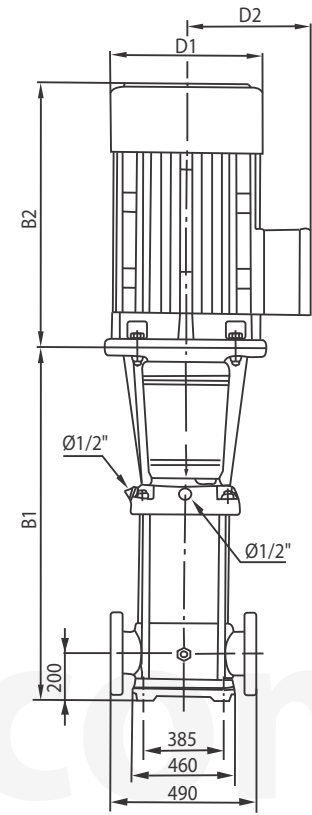
Monterrey, N.L. (Matriz)

D. Ladrón de Guevara 302 ote.
col. Del Norte C.P. 64500

☎ 81.8863.3737 / 81.8351.3737

☎ 81.8331.1777 / 81.8351.9609

✉ ventas-mx@barmesapumps.com

ventas@mannpumps.com (bombas ANSI)

ventas@genmann.com (plantas)

Ciudad de México

Calle Poniente 122 #419 bodega 2
col. Barrio de Coltongo, Azcapotzalco
entre calle Norte 35 y ave. Vallejo C.P. 02630

☎ 55.3004.9530 / 55.5029.6970

✉ ofmexico@barmesapumps.com

ofmexico@genmann.com (plantas)

Puebla, Puebla

Av. 15 Poniente #507 col. El Carmen
entre calles 5 y 7 Sur C.P. 72100

☎ 22.2774.8264 / 22.2774.8265

✉ ofpuebla@barmesapumps.com

Zapopan, Jalisco

Ramón Corona #295 col. Agua Blanca Industrial
entre calle Hidalgo y cerrada C.P. 45235

☎ 33.3875.1150 / 33.3875.1151

✉ ofzapopan@barmesapumps.com

ofzapopan@genmann.com (plantas)

Mérida, Yucatán

Calle 10 #206-A x 35 y 37

col. San Juan Grande C.P. 97145

☎ 999.919.0404 / 999.919.0599

✉ ofmerida@barmesapumps.com

Barmesa S.A.S. - Colombia

Calle 23 #116-31 bodegas 19 y 20
Parque Industrial Puerto Central
Módulo 2 Bogotá D.C. Colombia.

☎ +57 (1) 742.4453 / 742.4944

+57 (1) 742.5854 / 742.5855

✉ ventas-co@barmesapumps.com

Barmesa Pumps LLC - USA

103 Flecha Lane

Laredo, TX 78045 USA

☎ 844.BARMESA (2276372)

956.683.6480

1 Marion Ave.

Mansfield, Ohio 44903 USA

☎ +1 (419) 566.3318

✉ contact@barmesapumps.com